

Suregrip™ Ergo Tig Torch Range

EU/UK Terminations

SGT 9

Air-Cooled Tig Welding Torch
Rating: 125A DC, 90A AC @ 35% duty cycle.

PARKER
TORCHOLOGY

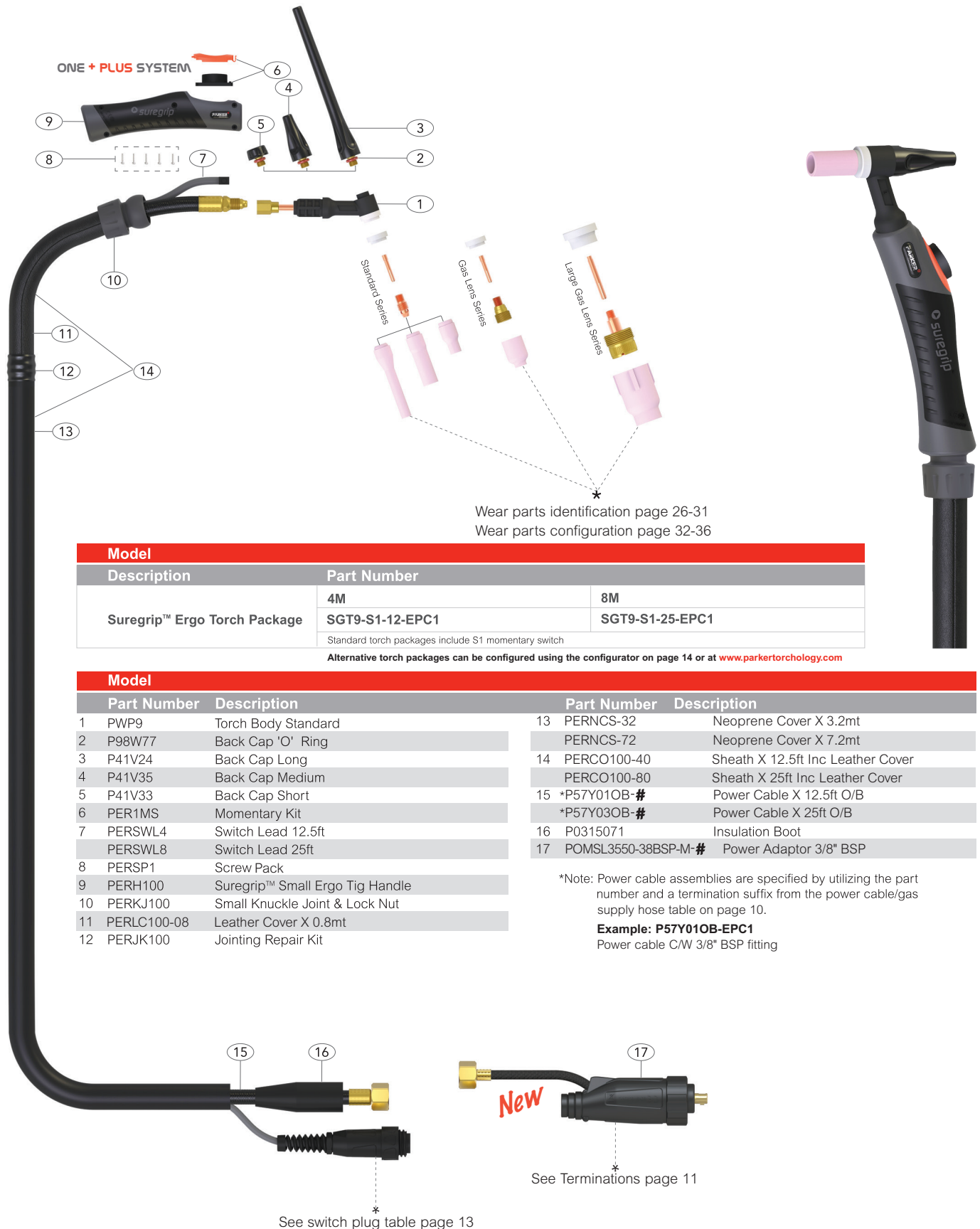

Model		
Description	Part Number	
Suregrip™ Ergo Torch Package	4M	8M
	SGT9-S1-12-EPC1	SGT9-S1-25-EPC1
Standard torch packages include S1 momentary switch		

Alternative torch packages can be configured using the configurator on page 14 or at www.parkertorchology.com

Model		
Part Number	Description	
1	PWP9	Torch Body Standard
2	P98W77	Back Cap 'O' Ring
3	P41V24	Back Cap Long
4	P41V35	Back Cap Medium
5	P41V33	Back Cap Short
6	PER1MS	Momentary Kit
7	PERSWL4	Switch Lead 12.5ft
	PERSWL8	Switch Lead 25ft
8	PERSP1	Screw Pack
9	PERH100	Suregrip™ Small Ergo Tig Handle
10	PERKJ100	Small Knuckle Joint & Lock Nut
11	PERLC100-08	Leather Cover X 0.8mt
12	PERJK100	Jointing Repair Kit

Part Number	Description	
13	PERNCS-32	Neoprene Cover X 3.2mt
	PERNCS-72	Neoprene Cover X 7.2mt
14	PERCO100-40	Sheath X 12.5ft Inc Leather Cover
	PERCO100-80	Sheath X 25ft Inc Leather Cover
15	*P57Y01OB-#	Power Cable X 12.5ft O/B
	*P57Y03OB-#	Power Cable X 25ft O/B
16	P0315071	Insulation Boot
17	POMSL3550-38BSP-M-#	Power Adaptor 3/8" BSP

*Note: Power cable assemblies are specified by utilizing the part number and a termination suffix from the power cable/gas supply hose table on page 10.

Example: P57Y01OB-EPC1
Power cable CAV 3/8" BSP fitting

*Note: Power cable assemblies are specified by utilizing the part number and a termination suffix from the power cable/gas supply hose table on page 10.

Example: P57Y01OB-EPC1
Power cable C/W 3/8" BSP fitting

SGT 17 Air-Cooled Tig Welding Torch
Rating: 150A DC, 105A AC @ 35% duty cycle.

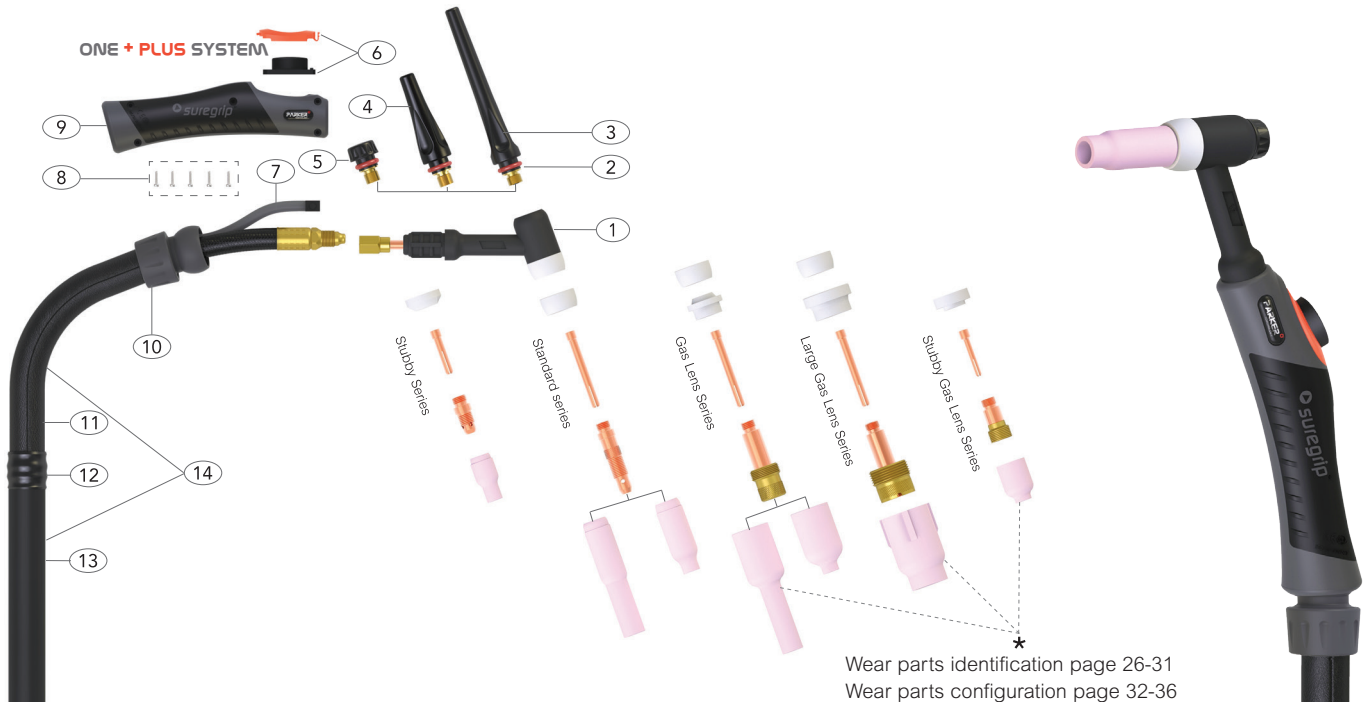

Model		
Description	Part Number	
	4M	8M
Suregrip™ Ergo Torch Package	SGT17-S1-12-EPC1	SGT17-S1-25-EPC1
Standard torch packages include S1 momentary switch		

Alternative torch packages can be configured using the configurator on page 14 or at www.parkertorchology.com

Model			
Part Number	Description	Part Number	Description
1 PWP17	Torch Body Standard	14 PERCO100-40	Sheath X 12.5ft Inc Leather Cover
2 P98W18	Back Cap 'O' Ring	PERCO100-80	Sheath X 25ft Inc Leather Cover
3 P57Y02	Back Cap Long	15 *P57Y01OB-#	Power Cable X 12.5ft O/B
4 P300M	Back Cap Medium	*P57Y03OB-#	Power Cable X 25ft O/B
5 P57Y04	Back Cap Short	16 P0315071	Insulation Boot
6 PER1MS	Momentary Kit	17 POMSL3550-38BSP-M-#	Power Adaptor 3/8" BSP
7 PERSWL4	Switch Lead 12.5ft		
PERSWL8	Switch Lead 25ft		
8 PERSP1	Screw Pack		
9 PERH100	Suregrip™ Small Ergo Tig Handle		
10 PERKJ100	Small Knuckle Joint & Lock Nut		
11 PERLC100-08	Leather Cover X 0.8mt		
12 PERJK100	Jointing Repair Kit		
13 PERNCS-32	Neoprene Cover X 3.2mt		
PERNCS-72	Neoprene Cover X 7.2mt		

*Note: Power cable assemblies are specified by utilizing the part number and a termination suffix from the power cable/gas supply hose table on page 10.

Example: P57Y01OB-EPC1
Power cable C/W 3/8" BSP fitting

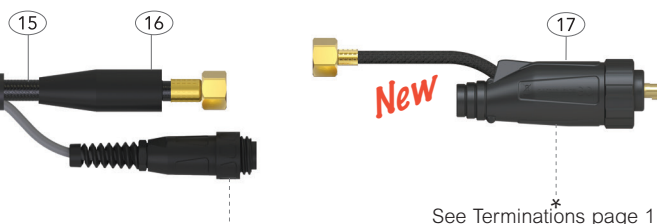

Suregrip™ Ergo Tig Torch Range

EU/UK Terminations

SGT 26

Air-Cooled Tig Welding Torch
Rating: 180A DC, 125A AC @ 35% duty cycle.

PARKER
TORCHOLOGY

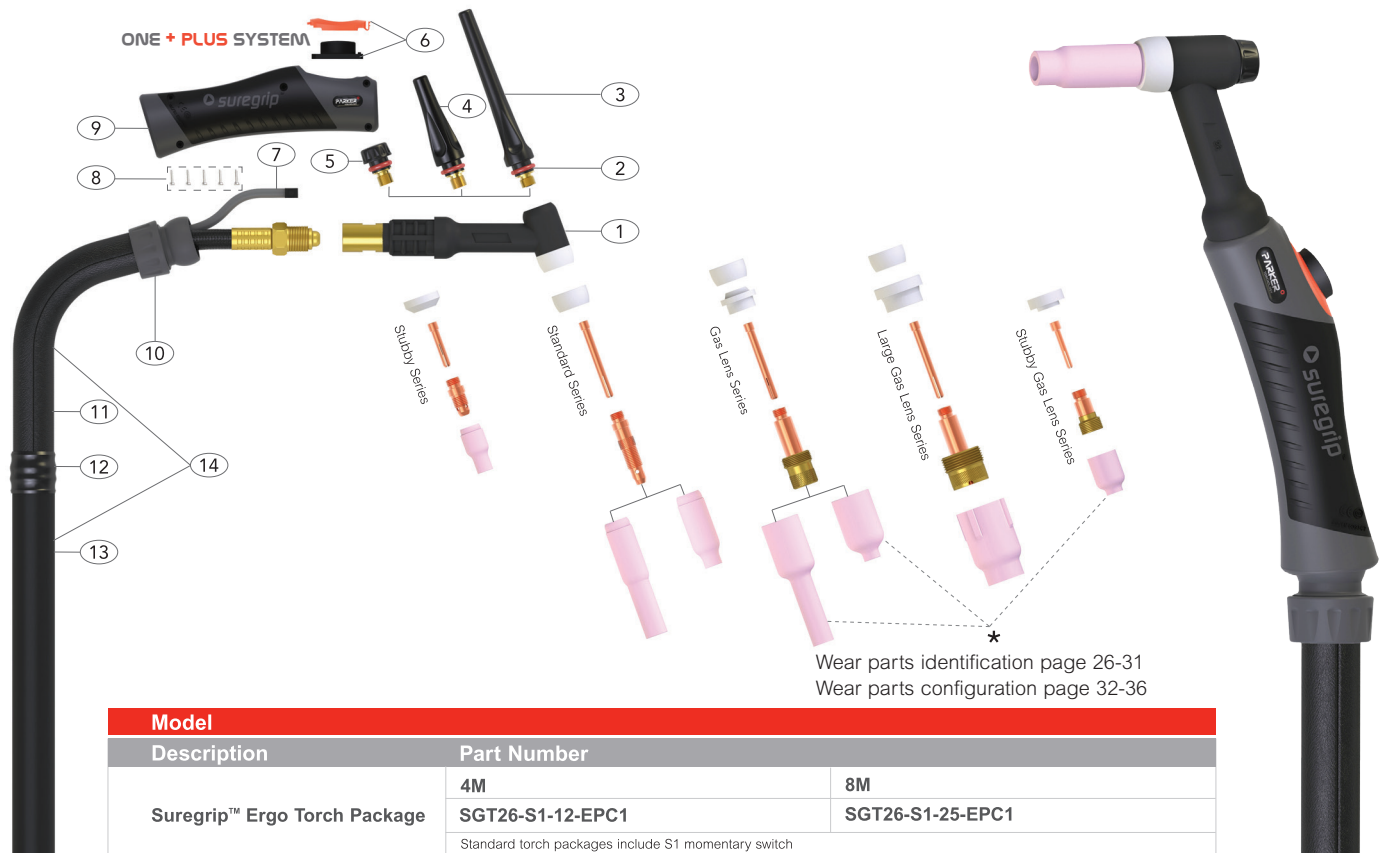

Wear parts identification page 26-31
Wear parts configuration page 32-36

Model		
Description	Part Number	
Suregrip™ Ergo Torch Package	4M	8M
	SGT26-S1-12-EPC1	SGT26-S1-25-EPC1
Standard torch packages include S1 momentary switch		

Alternative torch packages can be configured using the configurator on page 14 or at www.parkertorchology.com

Model			
Part Number	Description	Part Number	Description
1 PWP26	Torch Body Standard	14 PERCO200-40	Sheath X 12.5ft Inc Leather Cover
2 P98W18	Back Cap 'O' Ring	PERCO200-80	Sheath X 25ft Inc Leather Cover
3 P57Y02	Back Cap Long	15 P0315071	Insulation Boot
4 P300M	Back Cap Medium	16 *P46V280B-#	Power Cable X 12.5ft O/B
5 P57Y04	Back Cap Short	*P46V280B-#	Power Cable X 25ft O/B
6 PER1MS	Momentary Kit	17 POMSL3550-38BSP-L-#	Power Adaptor 3/8" BSP
7 PERSWL4	Switch Lead 12.5ft		
PERSWL8	Switch Lead 25ft		
8 PERSP1	Screw Pack		
9 PERH200	Suregrip™ Large Ergo Tig Handle		
10 PERKJ200	Large Knuckle Joint & Lock Nut		
11 PERLC200-08	Leather Cover X 0.8mt		
12 PERJK200	Jointing Repair Kit		
13 PERNCL-32	Neoprene Cover X 3.2mt		
PERNCL-72	Neoprene Cover X 7.2mt		

*Note: Power cable assemblies are specified by utilizing the part number and a termination suffix from the power cable/gas supply hose table on page 10.

Example: P46V280B-EPC1
Power cable C/W 3/8" BSP fitting

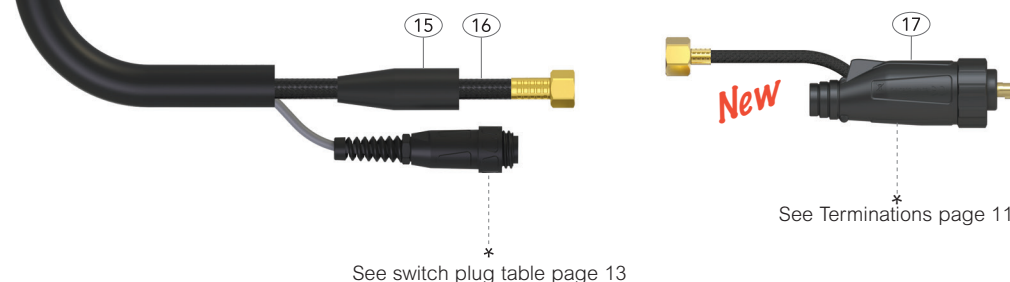

See switch plug table page 13

See Terminations page 11

Suregrip™ Ergo Tig Torch Range

EU/UK Terminations

SGT 125M

Air-Cooled Tig Welding Torch

Rating: PM9-90 head 95A DC, 65A AC @ 35% duty cycle.

Rating: PM17-90 head 150A DC, 105A AC @ 35% duty cycle.

PARKER
TORCHOLOGY

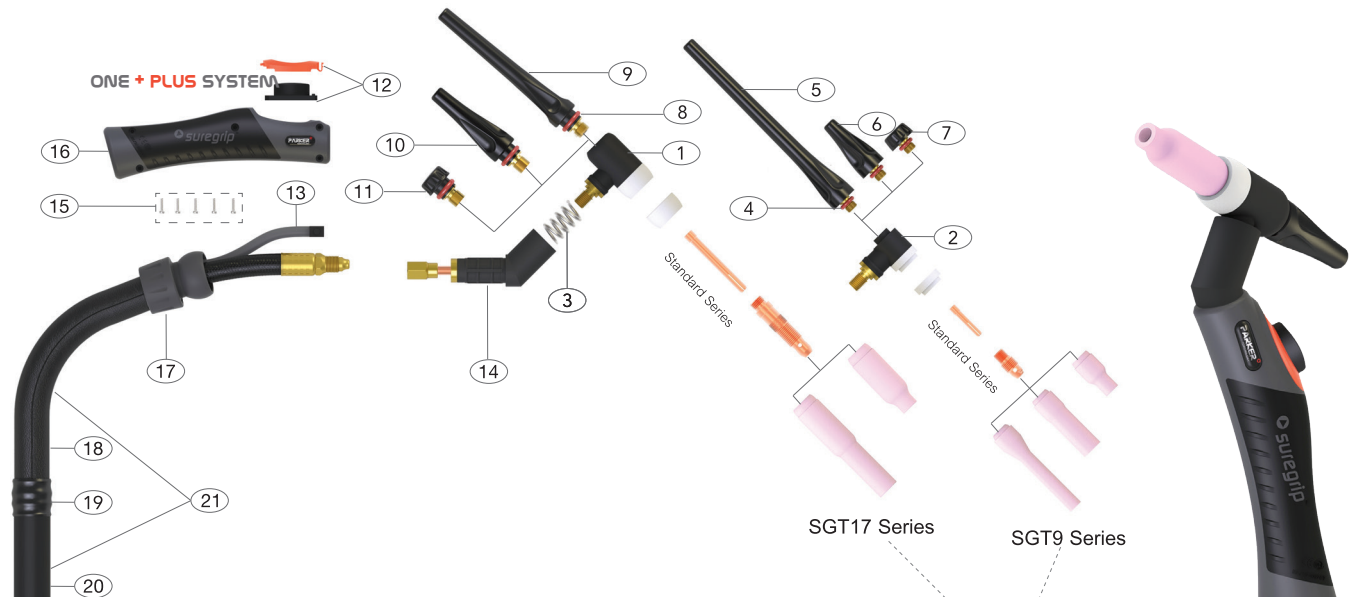

Model		
Description	Part Number	
Suregrip™ Ergo Torch Package	4M	8M
	SGTSF125M-UM17-90-S1-12-EPC1	SGTSF125M-UM17-90-S1-25-EPC1
Standard torch packages include S1 momentary switch		

Alternative torch packages can be configured using the configurator on page 14 or at www.parkertorchology.com

Model			
Part Number	Description	Part Number	Description
1	PM17-90 Torch Head 90° (Standard Set-up)	17	PERKJ100 Small Knuckle Joint & Lock Nut
2	PM17-90 Torch Head 90°	18	PERLC100-08 Leather Cover X 0.8mt
3	P4276270 Spring	19	PERJK100 Jointing Repair Kit
4	P98W77 Back Cap 'O' Ring	20	PERNCS-32 Neoprene Cover X 3.2mt
5	P41V24 Back Cap Long	21	PERNCS-72 Neoprene Cover X 7.2mt
6	P41V35 Back Cap Medium	22	PERCO100-40 Sheath X 12.5ft Inc Leather Cover
7	P41V33 Back Cap Short	23	PERCO100-80 Sheath X 25ft Inc Leather Cover
8	P98W18 Back Cap 'O' Ring	24	P0315071 Insulation Boot
9	P57Y02 Back Cap Long	25	*P57Y01OB-# Power Cable X 12.5ft O/B
10	P300M Back Cap Medium	26	*P57Y03OB-# Power Cable X 25ft O/B
11	P57Y04 Back Cap Short	27	POMSL3550-38BSP-M-# Power Adaptor 3/8" BSP
12	PER1MS Momentary Kit		
13	PERSWL4 Switch Lead 12.5ft		
14	PERSWL8 Switch Lead 25ft		
15	P125M Torch Body		
16	PERSP1 Screw Pack		
17	PERH100N Suregrip™ Small Ergo Tig Handle		

*Note: Power cable assemblies are specified by utilizing the part number and a termination suffix from the power cable/gas supply hose table on page 10.

Example: P57Y01OB-EPC1
Power cable C/W 3/8" BSP fitting

