

## SAF® - FRO® CP-40 R - CP-100R®

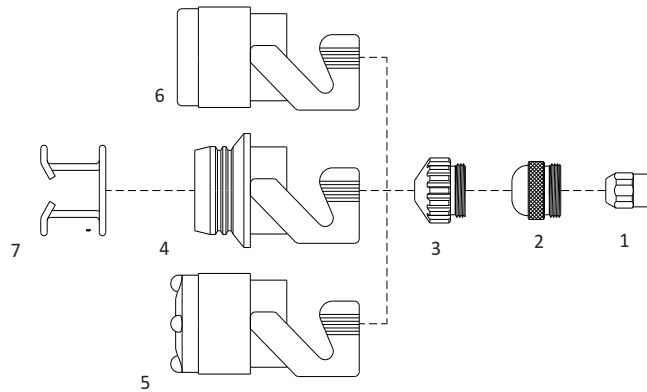

No.	Ref.	Code	Description	No.	Ref.	Code	Description
1	0408-2051	52014	Electrode Zr.	3	0408-2385	51118	Tip $\varnothing$ 1.6
	0408-2404	52514	Electrode Hf.	4	0408-2267	60426	TN Protection nozzle guide
2	0408-2052	51103	Tip 20/40	5	0408-2405	60427	TI Ceramic assembly with bosses
3	0408-2261	51104	Tip $\varnothing$ 1.0	6	0408-2268	60428	TI Ceramic guide
	0408-2262	51105	Tip $\varnothing$ 1.2	7	0408-2053	51901	Spacer spring

## PANASONIC®

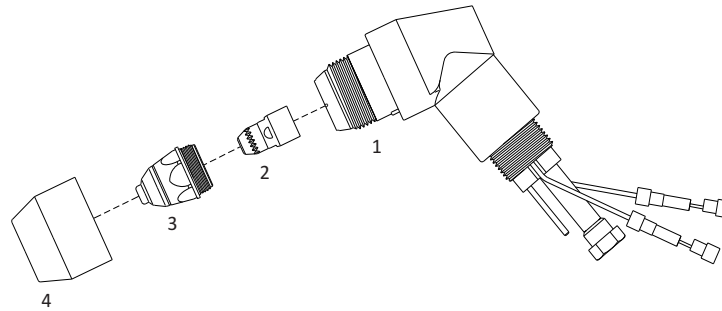

No.	Ref.	Code	Description	No.	Ref.	Code	Description
1	TKU08103	08000	Hand torch head	3	TET01130	51280.13	Tip $\varnothing$ 1.3 60A
2	TET02033	52790	Electrode		TET01512	51280.15	Tip $\varnothing$ 1.5 80A
3	TET01110	51280.10	Tip $\varnothing$ 1.0 40A	4	TGN02004	80045	Shield cap

## SMITH® - MERKLE®

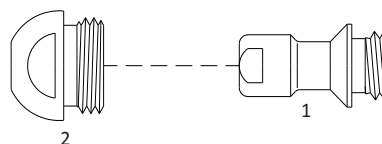

No.	Ref.	Code	Description	No.	Ref.	Code	Description
1	30808-5	52715	Electrode	2	30814-5	51572	Tip $\varnothing$ 1,4
2	30812-5	51570	Tip $\varnothing$ 1,0		30815-5	51573	Tip $\varnothing$ 1,6
	30813-5	51571	Tip $\varnothing$ 1,2		30344-5	51574	Tip $\varnothing$ 1,8