

Section 4

TIG

Torches & Consumables



WeldTronic
quality welding products

PARKER
TORCH TECHNOLOGY

SOREX

LEAR WELDING

TronicFill

TronicSafe

TronicFlame

Welttek

headuX

WELDAS

Suregrip™ Air-Cooled

Suregrip™ WLD

Welding Tools For The Professional

- Premium performance and feature sets
- High specification raw materials
- Simple is best design philosophy



Head and shoulders

Options include - Standard
Valve
Flexible
Multijust™



Grip it

Soft grips to keep it where its needed



"Plug and play"

Changed in under 5 seconds - try it

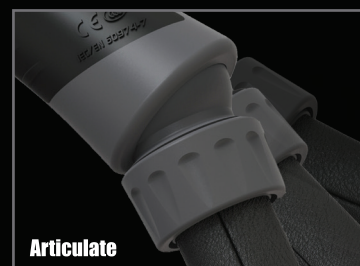

Articulate

Knuckle joints for precision movement



INNOVATION, TECHNOLOGY, PERFORMANCE

Suregrip™ Ergo Tig Torch Range

EU/UK Terminations

Features Focus

PARKER
TORCHOLOGY

Suregrip™ Water-Cooled

Premium Product and Feature Sets



Soft and supple

Dressed in leather



Optimum performance and flexibility

Superflex all rubber cable sets



Around the world

Termination options include - EU
UK
USA
Surelok™

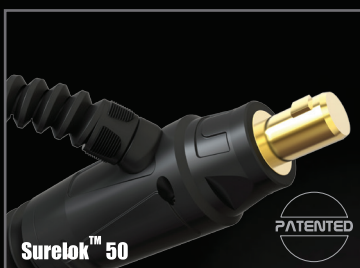

Surelok™ 50

One size fits all - guaranteed 50°
rotational lock

**Suregrip™ welding tools,,
when productivity counts.**





Technical Data	SGT 9	SGT 17	SGT 26	SGT 24W	SGT 20	SGT 20S
Cooling Method	Air-Cooled	Air-Cooled	Air-Cooled	Water-Cooled	Water-Cooled	Water-Cooled
Rating: DC	125A	150A	180A	180A	225A	340A
AC	90A	105A	125A	125A	160A	240A
Duty Cycle:	35%	35%	35%	100%	100%	100%
Electrode Size:	1.0-2.4	1.0-3.2	1.0-4.0	0.5-2.4	1.0-3.2	1.0-3.2
Minimum Water Flow	-	-	-	0.9 l/min	1.0 l/min	1.2L/min
Minimum Water Inlet Pressure	-	-	-	2.0Bar	2.0Bar	2.0Bar
Minimum Cooling Requirements	-	-	-	600W	700W	1000W
Maximum Water Inlet Pressure	-	-	-	5.0Bar	5.0Bar	5.0Bar
Maximum Water Inlet Temperature	-	-	-	50°C	50°C	50°C

Suregrip™ Ergo Tig Torch Range

EU/UK Terminations

Ratings: 125Amp to 410Amp



SPECIAL ACCESS SERIES

Infinite positionability

Limited access

Technical Data	SGT 18	SGT 18SC	SGT 125 Multijust™	SGT 250 Multijust™	SGT 225 Flex
Cooling Method	Water-Cooled	Water-Cooled	Air-Cooled	Water-Cooled	Water-Cooled
Rating: DC	380A	410A	150A	250A	225A
AC	270A	290A	105A	175A	160A
Duty Cycle:	100%	100%	35%	100%	100%
Electrode Size:	1.0-4.0	1.0-4.8	1.0-3.2	1.0-4.0	1.0-3.2
Minimum Water Flow	1.0 l/min	1.0 l/min	-	1.0 l/min	1.0 l/min
Minimum Water Inlet Pressure	2.0Bar	2.0Bar	-	2.0Bar	2.0Bar
Minimum Cooling Requirements	900W	1000W	-	800W	600W
Maximum Water Inlet Pressure	5.0Bar	5.0Bar	-	5.0Bar	5.0Bar
Maximum Water Inlet Temperature	50°C	50°C	-	50°C	50°C

Suregrip™ Ergo Tig Torch Heads are 100% Weldcraft OEM interchangeable.

Air and Water-Cooled torch bodies are offered with a choice of standard and flexible options. Flexible options have the ability to be manipulated into different positions.

In applications where torch head repositioning is a daily requirement, the special access series is recommended.



Air-Cooled Series

Suregrip™ SGT 9 Series Torch Body Options
0.040" - 3/32"/1.0mm-2.4mm electrodes.

Rating: 125A DC, 90A AC, @ 35%

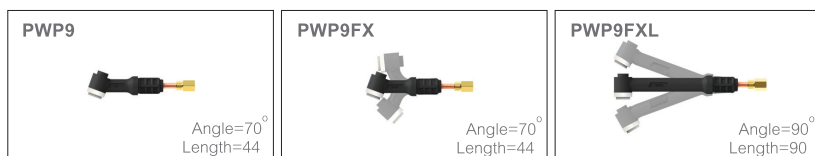

Suregrip™ SGT 17 Series Torch Body Options
0.040" - 1/8"/1.0mm-3.2mm electrodes.

Rating: 150A DC, 105A AC, @ 35%

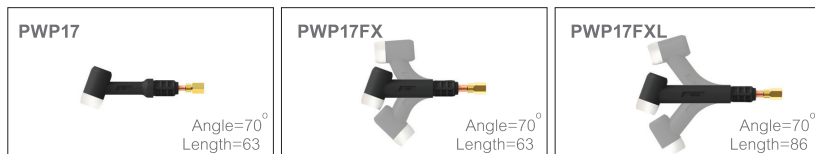

Suregrip™ SGT 26 Series Torch Body Options
0.040" - 5/32"/1.0mm-4.0mm electrodes.

Rating: 180A DC, 125A AC, @ 35%



Water-Cooled Series

Suregrip™ SGT 24W Series Torch Body Options
0.020" - 3/32"/0.5mm-2.4mm electrodes.

Rating: 180A DC, 125A AC, @ 100%



Suregrip™ Ergo Tig Torch Range

Torch Body Options

Suregrip™ SGT 20 Series Torch Body Options

0.040" - 1/8"/1.0mm-3.2mm electrodes.

Rating: 225A DC, 160A AC, @ 100%

Rating: 340A DC, 240A AC, @ 100%

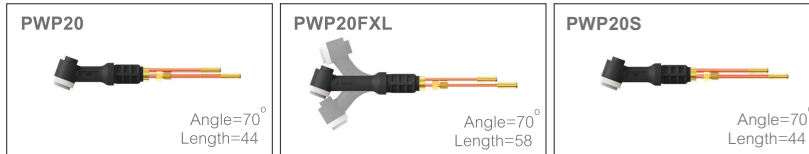

Suregrip™ SGT 18 Series Torch Body Options

0.040" - 5/32"/1.0mm-4.0mm electrodes.

Rating: 380A DC, 270A AC, @ 100%

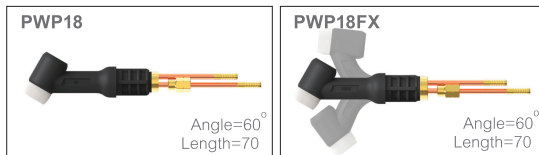

Suregrip™ SGT 18SC Series Torch Body Options

0.040" - 3/16"/1.0mm-4.8mm electrodes.

Rating: 410A DC, 290A AC, @ 100%



Special Access Series

Suregrip™ SGT 125 Multijust™ Series Torch Body Options

0.040" - 1/8"/1.0mm-3.2mm electrodes.

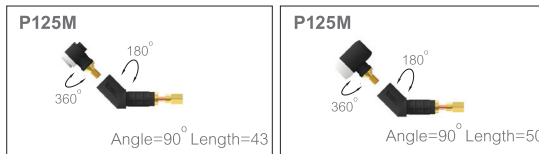

SGT 125 PM9-90

Rating: 95A DC, 65A AC @ 35%

SGT 125 PM17-90

Rating: 150A DC, 105A AC @ 35%

SGT 125, SGT 250 Multijust™ torch bodies are recommended in applications where repeated adjustments of the head position are an everyday occurrence. Available in Air-Cooled and Water-Cooled the heads are designed to rotate through 180° in the handle and through 360° from the two-piece torch body. Two head sizes allows the full range of Weldcraft compatible spare parts across both models.

Suregrip™ SGT 250 Multijust™ Series Torch Body Options

0.040" - 5/32"/1.0mm-4.0mm electrodes.



SGT 250 PM9-90

Rating: 225A DC, 160A AC @ 100%

SGT 250 PM17-90

Rating: 250A DC, 175A AC @ 100%

Key Features:

- Multiple angles from one torch body style.
- Small and large head sizes with SGT 9 and SGT 18 series wear parts range interchangeability.
- Standard collet and collet body, stubby gas lens, standard gas lens and large gas lens wear parts configurations.

The SGT 225 flex neck system has been designed to provide easy access to difficult to reach areas with one torch package and multiple head sizes and angles.

Suregrip™ SGT 225 Flex Series Torch Body Options

0.040" - 1/8"/1.0mm-3.2mm electrodes.

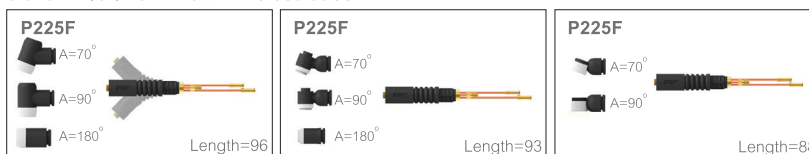

SGT 225 (P18 series heads)

Rating: 225A DC, 160A AC, @ 100%

SGT 225 (P20 series heads)

Rating: 200A DC, 140A AC, @ 100%

SGT 225 (P24 series heads)

Rating: 160A DC, 115A AC, @ 100%

Key Features:

- Multiple head style and angle interchangeability across one torch package
- Standard collet and collet body, stubby gas lens, standard gas lens, large gas lens wear parts configurations

Suregrip™ Ergo handle systems

Two sizes of handle are utilized for the range with a fully interchangeable series of switch options.



Switch Interchangeability

Switches are "plug and play" and can be exchanged in seconds without the use of tools.



Switch Modules ONE + PLUS SYSTEM

Torch packages are supplied with a 5 core "plug and play " switch wire assembly and a momentary switch as standard.

- Torch packages can be ordered with or without switches.
- All switch options interchange across the range.
- All replacement switch kits include switch modules and housings.

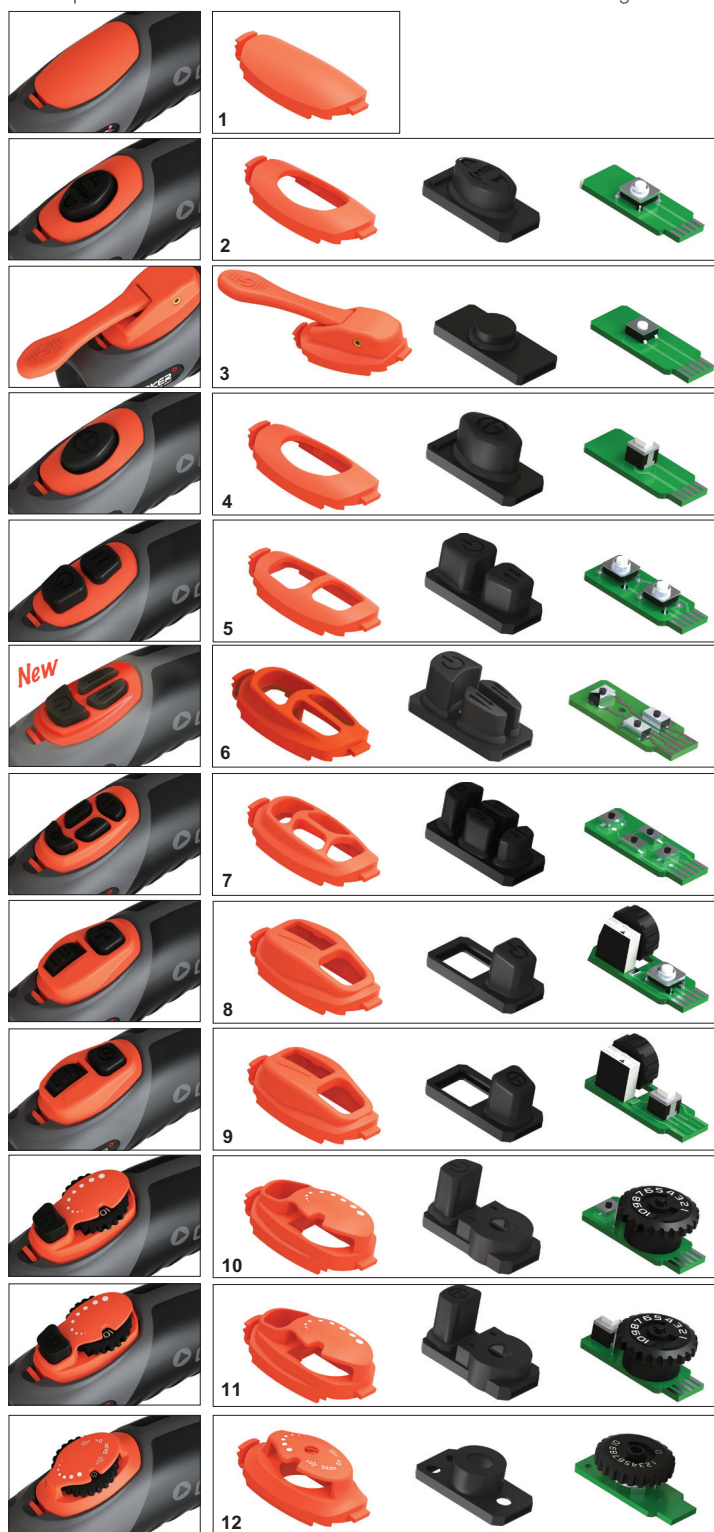

ONE + PLUS SYSTEM

Part No	Description
1 PERBS	Blank Kit
Part No	Description
2 PER1MS	Momentary Kit
Part No	Description
3 PER1LS	Lever Momentary Kit
Part No	Description
4 PER1MT	Maintained Switch Kit
Part No	Description
5 PER2MS	2 Button Momentary Kit
Part No	Description
6 PER3MS	3 Button Momentary Kit <i>New</i>
Part No	Description
7 PER4MS	4 Button Momentary Kit
Part No	Description
8 PER1MS-1	Button Momentary Kit+1K Vertical Potentiometer
PER1MS-5	Button Momentary Kit+5K Vertical Potentiometer
PER1MS-10	Button Momentary Kit+10K Vertical Potentiometer
PER1MS-25	Button Momentary Kit+25K Vertical Potentiometer
Part No	Description
9 PER1MT-1	Button Maintained Kit+1K Vertical Potentiometer
PER1MT-5	Button Maintained Kit+5K Vertical Potentiometer
PER1MT-10	Button Maintained Kit+10K Vertical Potentiometer
PER1MT-25	Button Maintained Kit+25K Vertical Potentiometer
Part No	Description
10 PER1MS-1H	Button Momentary Kit+1K Horizontal Potentiometer
PER1MS-5H	Button Momentary Kit+5K Horizontal Potentiometer
PER1MS-10H	Button Momentary Kit+10K Horizontal Potentiometer
PER1MS-25H	Button Momentary Kit+25K Horizontal Potentiometer
Part No	Description
11 PER1MT-1H	Button Maintained Kit+1K Horizontal Potentiometer
PER1MT-5H	Button Maintained Kit+5K Horizontal Potentiometer
PER1MT-10H	Button Maintained Kit+10K Horizontal Potentiometer
PER1MT-25H	Button Maintained Kit+25K Horizontal Potentiometer
Part No	Description
12 PER1MTS-1H	Rotate on/off 1K Potentiometer Switch Kit
PER1MTS-5H	Rotate on/off 5K Potentiometer Switch Kit
PER1MTS-10H	Rotate on/off 10K Potentiometer Switch Kit
PER1MTS-25H	Rotate on/off 25K Potentiometer Switch Kit

Air-Cooled

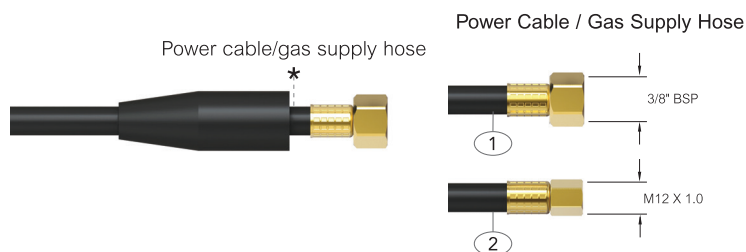

# Power Cable / Gas Supply Hose		
Part Number	Description	
1 EPC1	Power Cable C/W 3/8" BSP	
2 EPC2	Power Cable C/W M12 x 1.0	

Water-Cooled

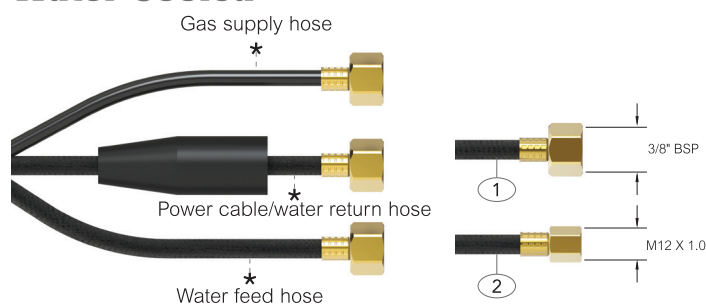

# Power Cable / Water Return Hose		
Part Number	Description	
1 EPC1	Power Cable C/W 3/8" BSP	
2 EPC2	Power Cable C/W M12 x 1.0	

Water Feed Connection Options

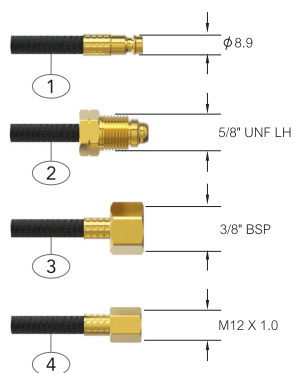

Gas Supply Hose

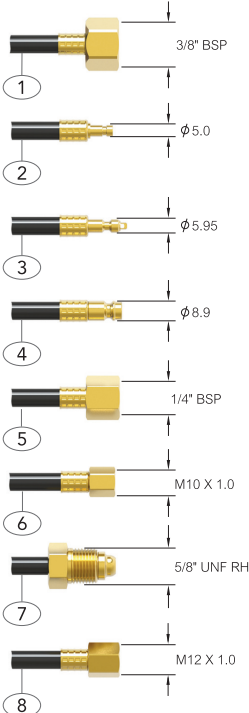

# Water Feed Hose		
Part Number	Description	
1 WF1	Water Feed Hose C/W 8.9mm Quick Fit	
2 WF2	Water Feed Hose C/W 5/8" UNF LH	
3 WF3	Water Feed Hose C/W 3/8" BSP	
4 WF4	Water Feed Hose C/W M12 x 1.0	

# Gas Supply Hose		
Part Number	Description	
1 GS1	Gas Supply Hose C/W 3/8" BSP	
2 GS2	Gas Supply Hose C/W 5.0mm Quick Fit	
3 GS3	Gas Supply Hose C/W 5.95mm Quick Fit	
4 GS4	Gas Supply Hose C/W 8.9mm Quick Fit	
5 GS5	Gas Supply Hose C/W 1/4" BSP	
6 GS6	Gas Supply Hose C/W M10 x 1.0	
7 GS7	Gas Supply Hose C/W 5/8" UNF RH	
8 GS8	Gas Supply Hose C/W M12 x 1.0	

Suregrip™ Ergo Tig Torch Range

EU/UK MSL DIRECT Terminations

New

MSL Cable Adaptors-UK Series 3/8" BSP Connection

Ordering Information

Termination option part numbering is configured using the simple 4 stage system outlined below.

1. Select the Plug Type
2. Select the Power Cable Termination Type
3. Select the Support Bore Size
4. Select the Gas / Water Connector Type

Example:-POML1025-38BSP-S-GW1

MSL 16mm Dinse Type Connector For a WP20 Power Cable With 3/8" BSP Gas / Water Connection.

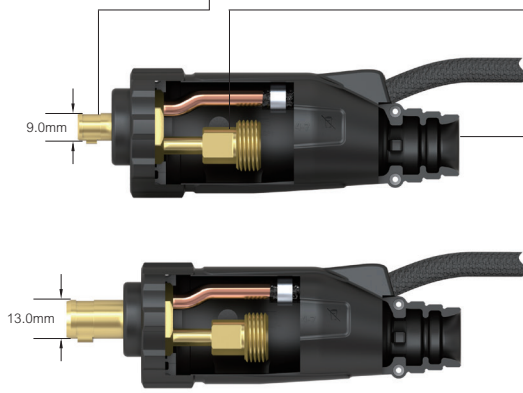
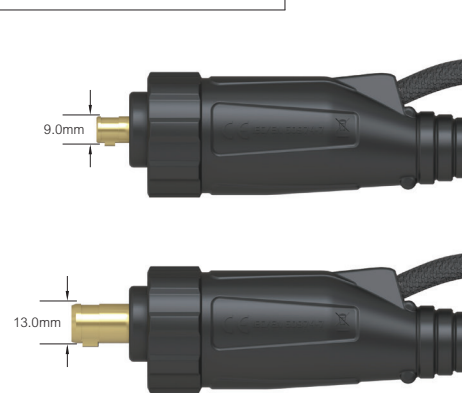
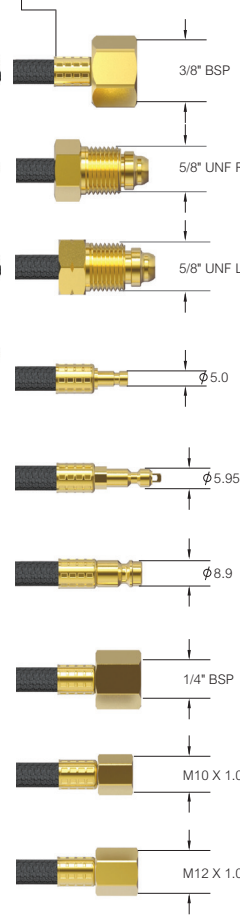
Step 1	Step 2	Step 3	Step 4
Plug Type	Power Cable Connector	Bore Size	Gas / Water Connections
			<p>3/8" BSP</p> <p>5/8" UNF RH</p> <p>5/8" UNF LH</p> <p>Ø 5.0</p> <p>Ø 5.95</p> <p>Ø 8.9</p> <p>1/4" BSP</p> <p>M10 X 1.0</p> <p>M12 X 1.0</p>

Step 1	Step 2	Step 3	Step 4																												
Plug Type	Power Cable Connector	Bore Size	Gas / Water Connections																												
<table border="1"> <thead> <tr> <th>Part No.</th> <th>Description</th> </tr> </thead> <tbody> <tr> <td>ML1025</td> <td>16mm Power Adaptor</td> </tr> <tr> <td>ML3550</td> <td>35mm Power Adaptor</td> </tr> </tbody> </table>	Part No.	Description	ML1025	16mm Power Adaptor	ML3550	35mm Power Adaptor		<table border="1"> <thead> <tr> <th>Part No.</th> <th>Description</th> <th>Model</th> </tr> </thead> <tbody> <tr> <td>S</td> <td>Cover 10mm Bore</td> <td>20/24W/250M/225F</td> </tr> <tr> <td>M</td> <td>Cover 13mm Bore</td> <td>9/17/18/18SC/125M</td> </tr> <tr> <td>L</td> <td>Cover 16mm Bore</td> <td>26</td> </tr> </tbody> </table>	Part No.	Description	Model	S	Cover 10mm Bore	20/24W/250M/225F	M	Cover 13mm Bore	9/17/18/18SC/125M	L	Cover 16mm Bore	26											
Part No.	Description																														
ML1025	16mm Power Adaptor																														
ML3550	35mm Power Adaptor																														
Part No.	Description	Model																													
S	Cover 10mm Bore	20/24W/250M/225F																													
M	Cover 13mm Bore	9/17/18/18SC/125M																													
L	Cover 16mm Bore	26																													
<table border="1"> <thead> <tr> <th>Part No.</th> <th>Description</th> </tr> </thead> <tbody> <tr> <td>38BSP</td> <td>3/8" BSP EU/UK Power Cable Connection</td> </tr> <tr> <td>38UNF</td> <td>3/8" UNF USA Power Cable Connection</td> </tr> <tr> <td>M12</td> <td>M12X1.0 European Power Cable Connection</td> </tr> </tbody> </table>	Part No.	Description	38BSP	3/8" BSP EU/UK Power Cable Connection	38UNF	3/8" UNF USA Power Cable Connection	M12	M12X1.0 European Power Cable Connection		<table border="1"> <thead> <tr> <th>Part No.</th> <th>Description</th> </tr> </thead> <tbody> <tr> <td>GW1</td> <td>3/8" BSP Gas / Water Connections</td> </tr> <tr> <td>G2</td> <td>5/8" UNF RH Gas Connections</td> </tr> <tr> <td>W3</td> <td>5/8" UNF LH Water Connections</td> </tr> <tr> <td>G8</td> <td>5.0mm Quick Fit Gas Connections</td> </tr> <tr> <td>G4</td> <td>5.95mm Quick Fit Gas Connections</td> </tr> <tr> <td>GW7</td> <td>8.9mm Quick Fit Gas / Water Connections</td> </tr> <tr> <td>G5</td> <td>1/4" BSP Gas Connections</td> </tr> <tr> <td>G6</td> <td>M10X1.0 Gas Connections</td> </tr> <tr> <td>GW9</td> <td>M12X1.0 Gas Connections</td> </tr> </tbody> </table>	Part No.	Description	GW1	3/8" BSP Gas / Water Connections	G2	5/8" UNF RH Gas Connections	W3	5/8" UNF LH Water Connections	G8	5.0mm Quick Fit Gas Connections	G4	5.95mm Quick Fit Gas Connections	GW7	8.9mm Quick Fit Gas / Water Connections	G5	1/4" BSP Gas Connections	G6	M10X1.0 Gas Connections	GW9	M12X1.0 Gas Connections	
Part No.	Description																														
38BSP	3/8" BSP EU/UK Power Cable Connection																														
38UNF	3/8" UNF USA Power Cable Connection																														
M12	M12X1.0 European Power Cable Connection																														
Part No.	Description																														
GW1	3/8" BSP Gas / Water Connections																														
G2	5/8" UNF RH Gas Connections																														
W3	5/8" UNF LH Water Connections																														
G8	5.0mm Quick Fit Gas Connections																														
G4	5.95mm Quick Fit Gas Connections																														
GW7	8.9mm Quick Fit Gas / Water Connections																														
G5	1/4" BSP Gas Connections																														
G6	M10X1.0 Gas Connections																														
GW9	M12X1.0 Gas Connections																														

Cable Adaptor

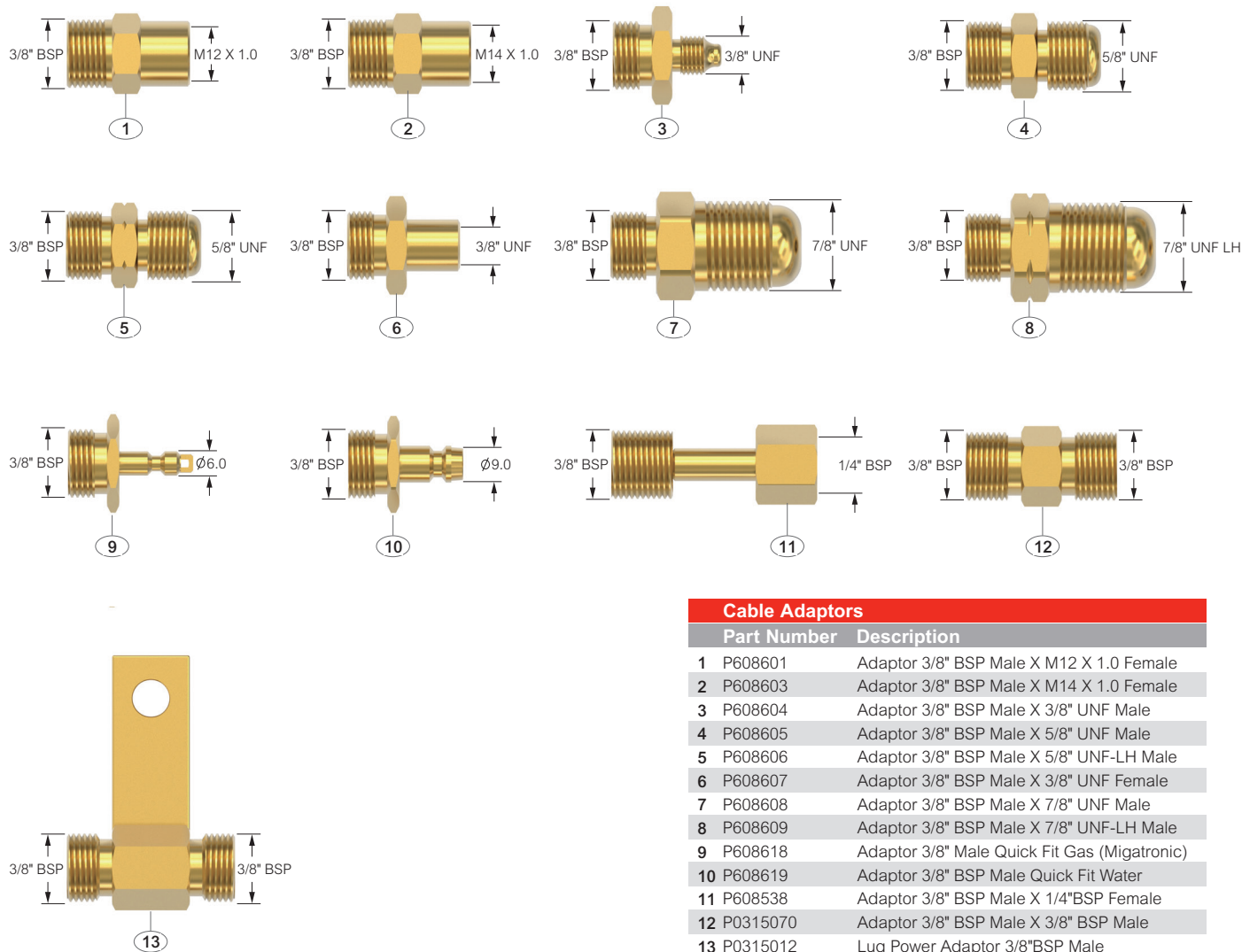

Cable Adaptors		
Part Number	Description	
1 P608601	Adaptor 3/8" BSP Male X M12 X 1.0 Female	
2 P608603	Adaptor 3/8" BSP Male X M14 X 1.0 Female	
3 P608604	Adaptor 3/8" BSP Male X 3/8" UNF Male	
4 P608605	Adaptor 3/8" BSP Male X 5/8" UNF Male	
5 P608606	Adaptor 3/8" BSP Male X 5/8" UNF-LH Male	
6 P608607	Adaptor 3/8" BSP Male X 3/8" UNF Female	
7 P608608	Adaptor 3/8" BSP Male X 7/8" UNF Male	
8 P608609	Adaptor 3/8" BSP Male X 7/8" UNF-LH Male	
9 P608618	Adaptor 3/8" Male Quick Fit Gas (Migatronic)	
10 P608619	Adaptor 3/8" BSP Male Quick Fit Water	
11 P608538	Adaptor 3/8" BSP Male X 1/4" BSP Female	
12 P0315070	Adaptor 3/8" BSP Male X 3/8" BSP Male	
13 P0315012	Lug Power Adaptor 3/8" BSP Male	

Suregrip™ Ergo Tig Torch Range

Switch Wire Plugs



Kit Order Codes

Part Number	Description
PERCP0	2 Pin Amphenol Plug

Kit Order Codes

Part Number	Description
PERCP1	4 Pin Amphenol Plug

Kit Order Codes

Part Number	Description
PERCP2	5 Pin Amphenol Plug

Kit Order Codes

Part Number	Description
PERCP3	6 Pin Amphenol Plug

Kit Order Codes

Part Number	Description
PERCP4	14 Pin Amphenol Plug

Kit Order Codes

Part Number	Description
PERCP6	8 Pin Amphenol Plug
PERCP6-5	5 Pin Amphenol Plug

Kit Order Codes

Part Number	Description
PERCP7	3 Pin Tuchel Plug

Kit Order Codes

Part Number	Description
PERCP8	9 Pin Tuchel Plug

Kit Order Codes

Part Number	Description
PERCP9	5 Pin Tuchel Plug

Kit Order Codes

Part Number	Description
PERCP11	7 Pin Uniarc Plug

Kit Order Codes

Part Number	Description
PXS12-J3P	3 Pin Plug

Torch Package Configurator

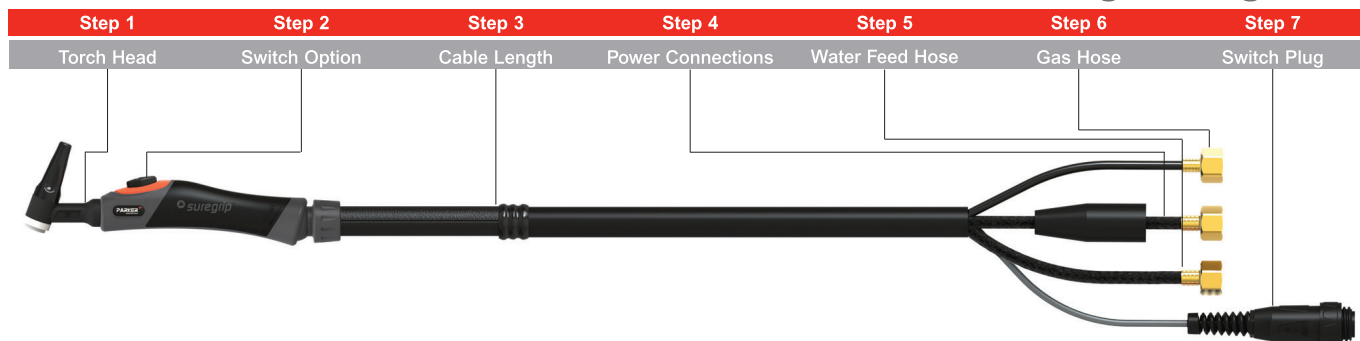

Ordering Information

Torch package part numbering is configured using the simple 7 stage system outlined below.

1. Select the correct model of torch head
2. Select the switch option required
3. Select the length of cable required
4. Select the power cable termination required
5. Select the correct water connections
6. Select the correct gas connections
7. Add a cable plug if required

Example:- SGT18FX-S1-12-EPC1-WF3-GS1-PERCP11

Suregrip™ SGT18FX Ergo Torch x 12ft with momentary switch, 3/8" BSP power cable water & gas hoses and 7 pin Uniarc plug.

	Step 1	Step 2	Step 3	Step 4	Step 5	Step 6	Step 7
	Torch Head	Switch Option	Cable Length	Power Connections	Water Feed Hose	Gas Hose	Switch Plug
Air-Cooled	Part No.	Description	# Power Cable / Water Return Hose		Part No		
	SGT9	125A DC	Part No.		Description		
	SGT9FX	125A DC FLEX	EPC1		PERCP0		
	SGT9FXL	125A DC FLEX LONG	EPC2		PERCP1		
	SGT17	150A DC	NOTE: See page 10 for EU/UK terminations explanation		PERCP2		
	SGT17FX	150A DC FLEX	EPC1-MSL#-#-#-#		PERCP3		
	SGT17FXL	150A DC FLEX LONG	EPC2-MSL#-#-#-#		PERCP4		
	SGT26	180A DC	NOTE: See page 11 for MSL Cable Adaptor explanation		PERCP6		
	SGT26FX	180A DC FLEX	# Water Feed Hose		PERCP6-5		
	Water-Cooled	SGT24W	180A DC	Part No.		Description	
SGT20		225A DC	WF1		PERCP7		
SGT20FXL		225A DC FLEX LONG	WF2		PERCP8		
SGT20S		340A DC	WF3		PERCP9		
SGT18		380A DC	WF4		PERCP11		
SGT18FX		380A DC FLEX	NOTE: See page 10 for EU/UK terminations explanation		PXS12-J3P		
Special Access	SGT18SC	410A DC	Part No.		# Gas Supply Hose		
	SGTSF125M	150A DC	Description		Part No.		
	SGTSF250M	250A DC	12		Description		
	SGTSF225	225A DC FLEX	25		GS1		
NOTE: See page 6 for torch heads explanation		37		GS2			
		50		GS3			
		NOTE: See page 10 for EU/UK terminations explanation		GS4			
				GS5			
				GS6			
				GS7			
				GS8			
				NOTE: See page 10 for EU/UK terminations explanation			
				1THS			
				2THS			
				3THS			
				4THS			
				NOTE: See page 9 for switches explanation			

SGT 9



SGT 17 Air-Cooled Tig Welding Torch
Rating: 150A DC, 105A AC @ 35% duty cycle.

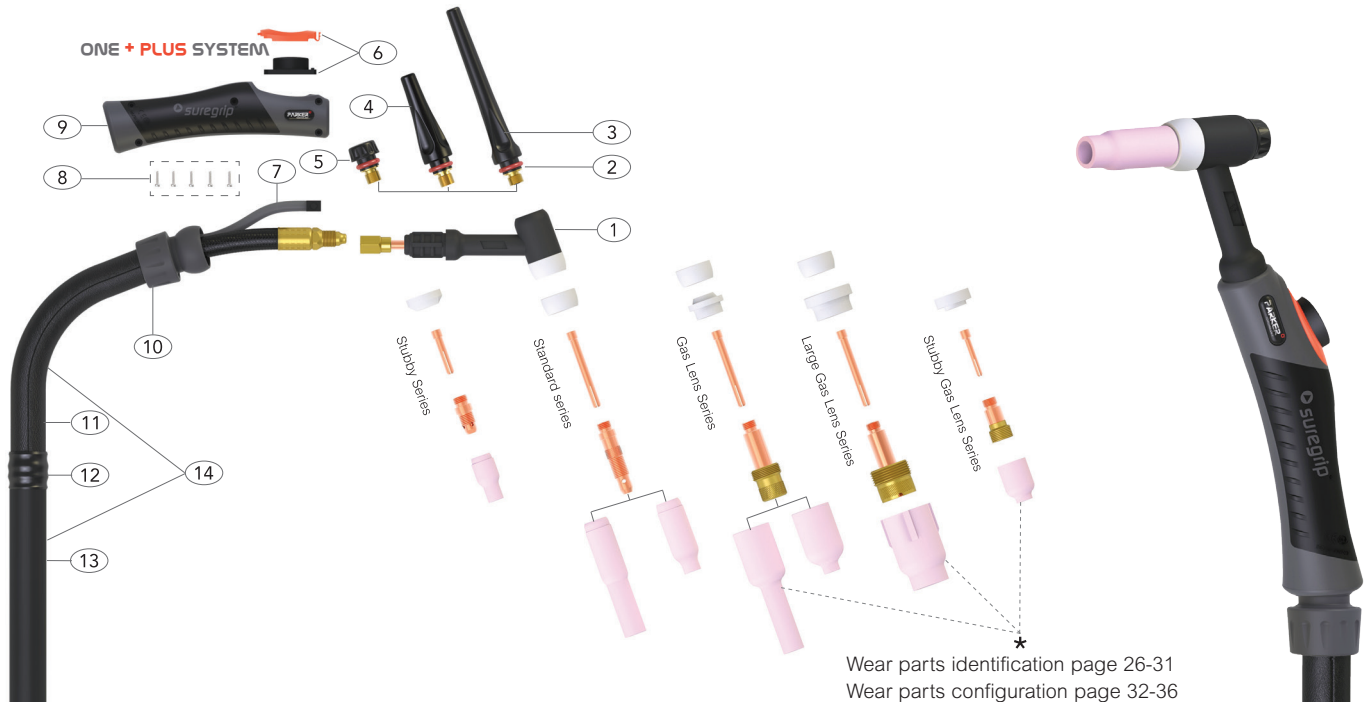

Model		
Description	Part Number	
Suregrip™ Ergo Torch Package	4M	8M
	SGT17-S1-12-EPC1	SGT17-S1-25-EPC1
Standard torch packages include S1 momentary switch		

Alternative torch packages can be configured using the configurator on page 14 or at www.parkertorchology.com

Model			
Part Number	Description	Part Number	Description
1 PWP17	Torch Body Standard	14 PERCO100-40	Sheath X 12.5ft Inc Leather Cover
2 P98W18	Back Cap 'O' Ring	PERCO100-80	Sheath X 25ft Inc Leather Cover
3 P57Y02	Back Cap Long	15 *P57Y01OB-#	Power Cable X 12.5ft O/B
4 P300M	Back Cap Medium	*P57Y03OB-#	Power Cable X 25ft O/B
5 P57Y04	Back Cap Short	16 P0315071	Insulation Boot
6 PER1MS	Momentary Kit	17 POMSL3550-38BSP-M-#	Power Adaptor 3/8" BSP
7 PERSWL4	Switch Lead 12.5ft		
PERSWL8	Switch Lead 25ft		
8 PERSP1	Screw Pack		
9 PERH100	Suregrip™ Small Ergo Tig Handle		
10 PERKJ100	Small Knuckle Joint & Lock Nut		
11 PERLC100-08	Leather Cover X 0.8mt		
12 PERJK100	Jointing Repair Kit		
13 PERNCS-32	Neoprene Cover X 3.2mt		
PERNCS-72	Neoprene Cover X 7.2mt		

*Note: Power cable assemblies are specified by utilizing the part number and a termination suffix from the power cable/gas supply hose table on page 10.

Example: P57Y01OB-EPC1
Power cable C/W 3/8" BSP fitting

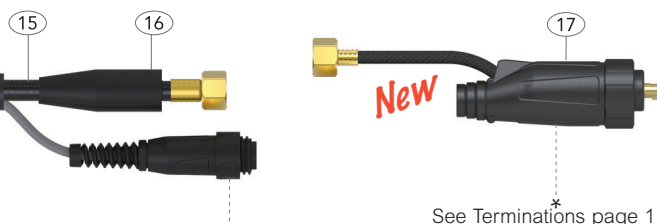

Suregrip™ Ergo Tig Torch Range

EU/UK Terminations

PARKER
TORCHOLOGY

SGT 26

Air-Cooled Tig Welding Torch
Rating: 180A DC, 125A AC @ 35% duty cycle.

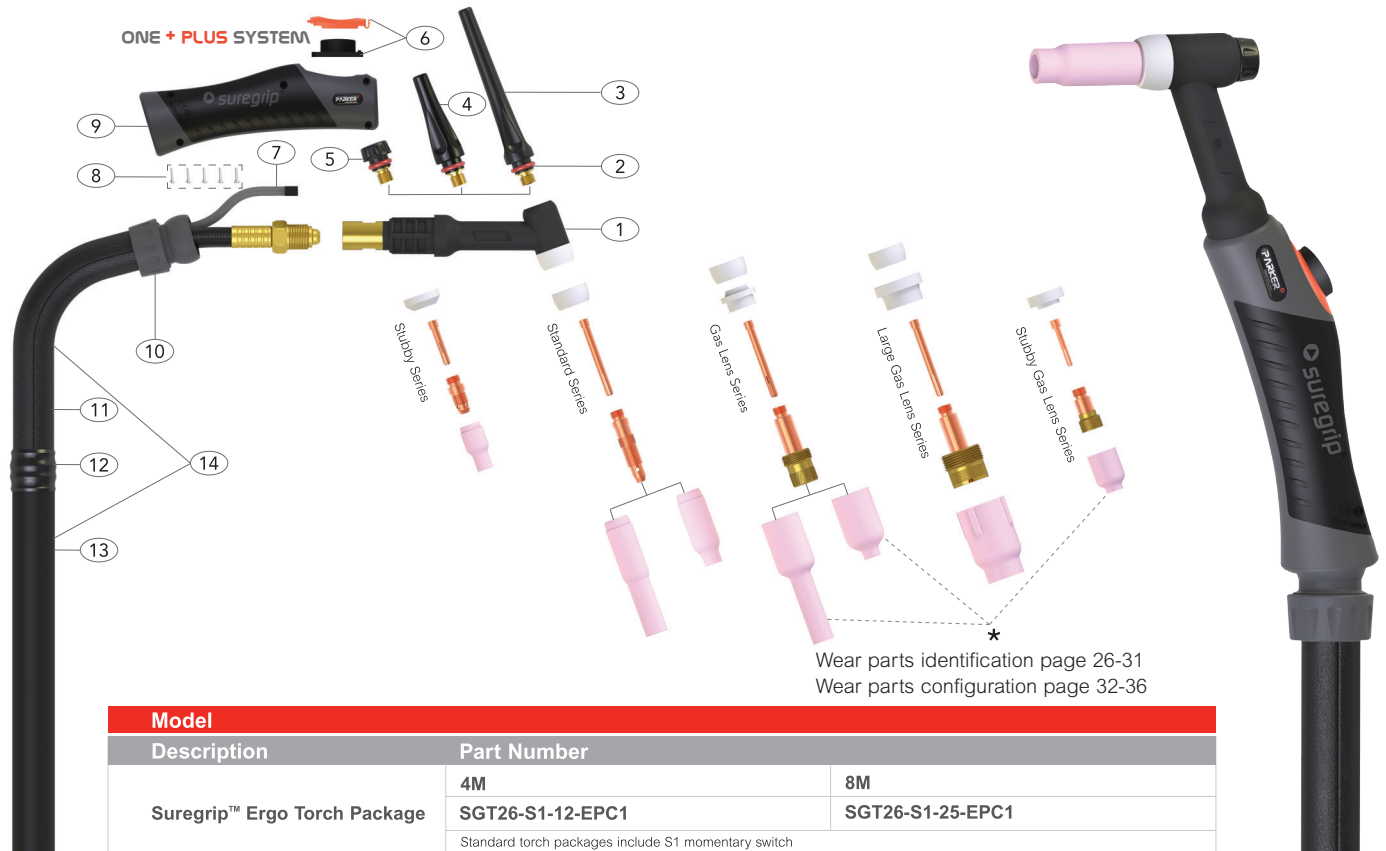

Wear parts identification page 26-31
Wear parts configuration page 32-36

Model		
Description	Part Number	
Suregrip™ Ergo Torch Package	4M	8M
	SGT26-S1-12-EPC1	SGT26-S1-25-EPC1
Standard torch packages include S1 momentary switch		

Alternative torch packages can be configured using the configurator on page 14 or at www.parkertorchology.com

Model			
Part Number	Description	Part Number	Description
1 PWP26	Torch Body Standard	14 PERCO200-40	Sheath X 12.5ft Inc Leather Cover
2 P98W18	Back Cap 'O' Ring	PERCO200-80	Sheath X 25ft Inc Leather Cover
3 P57Y02	Back Cap Long	15 P0315071	Insulation Boot
4 P300M	Back Cap Medium	16 *P46V280B-#	Power Cable X 12.5ft O/B
5 P57Y04	Back Cap Short	*P46V280B-#	Power Cable X 25ft O/B
6 PER1MS	Momentary Kit	17 POMSL3550-38BSP-L-#	Power Adaptor 3/8" BSP
7 PERSWL4	Switch Lead 12.5ft		
PERSWL8	Switch Lead 25ft		
8 PERSP1	Screw Pack		
9 PERH200	Suregrip™ Large Ergo Tig Handle		
10 PERKJ200	Large Knuckle Joint & Lock Nut		
11 PERLC200-08	Leather Cover X 0.8mt		
12 PERJK200	Jointing Repair Kit		
13 PERNCL-32	Neoprene Cover X 3.2mt		
PERNCL-72	Neoprene Cover X 7.2mt		

*Note: Power cable assemblies are specified by utilizing the part number and a termination suffix from the power cable/gas supply hose table on page 10.

Example: P46V280B-EPC1
Power cable C/W 3/8" BSP fitting

See switch plug table page 13

See Terminations page 11

SGT 24W

Water-Cooled Tig Welding Torch
Rating: 180A DC, 125A AC @ 100% duty cycle.

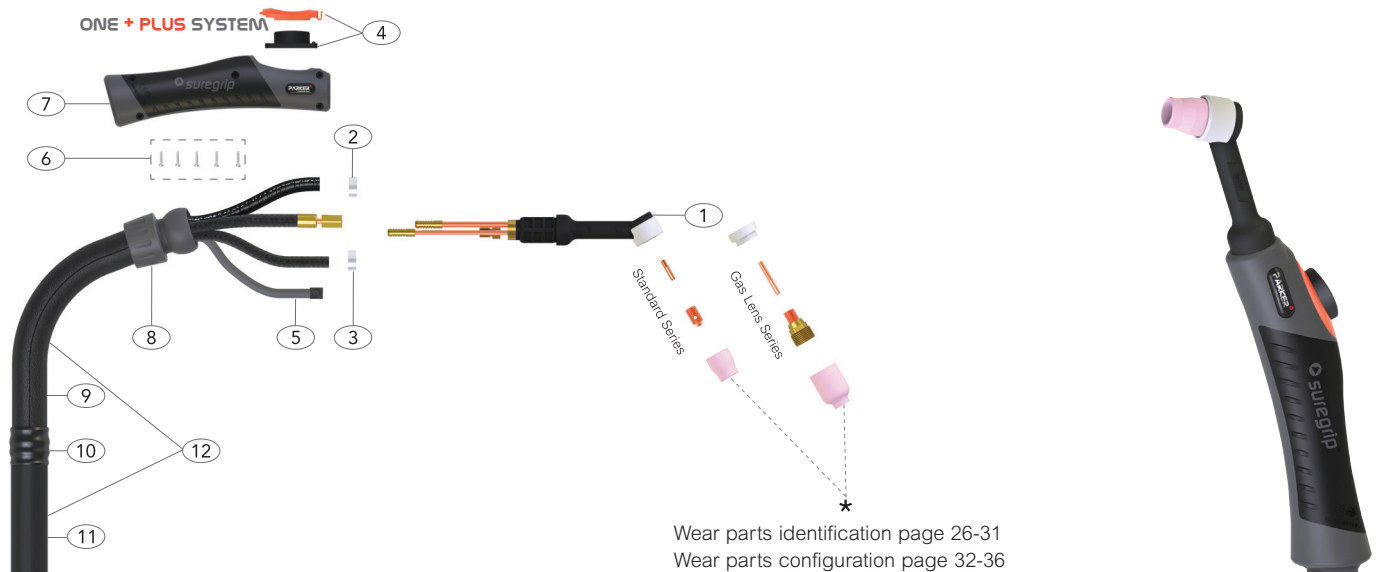

Model		
Description	Part Number	
	4M	8M
Suregrip™ Ergo Torch Package	SGT24W-S1-12-EPC1-WF3-GS1	SGT24W-S1-25-EPC1-WF3-GS1
Standard torch packages include S1 momentary switch		

Alternative torch packages can be configured using the configurator on page 14 or at www.parkertorchology.com

Model			
Part Number	Description	Part Number	Description
1	PWP24W Torch Body Standard	13	P0315071 Insulation Boot
2	PB5025S Gas Hose Clamp 8.0mm	14	*P45V03OB-# Power Cable X 12.5ft O/B
3	PB5041 Water Hose Clamp 8.7mm		*P45V04OB-# Power Cable X 25ft O/B
4	PER1MS Momentary Kit	15	*PN45V07OB-# Water Hose X 12.5ft O/B
5	PERSWL4 Switch Lead 12.5ft		*PN45V08OB-# Water Hose X 25ft O/B
	PERSWL8 Switch Lead 25ft	16	*P45V09-# Gas Hose X 12.5ft PVC
6	PERSP1 Screw Pack		*P45V10-# Gas Hose X 25ft PVC
7	PERH100 Suregrip™ Small Ergo Tig Handle	17	POMSL3550-38BSP-S-# Power Adaptor 3/8" BSP
8	PERKJ100 Small Knuckle Joint & Lock Nut		
9	PERLC100-08 Leather Cover X 0.8mt		
10	PERJK100 Jointing Repair Kit		
11	PERNCS-32 Neoprene Cover X 3.2mt		
	PERNCS-72 Neoprene Cover X 7.2mt		
12	PERCO100-40 Sheath X 12.5ft Inc Leather Cover		
	PERCO100-80 Sheath X 25ft Inc Leather Cover		

*Note: Power cable, gas and water hose assemblies are configured by utilizing the main part number and a termination suffix from the appropriate termination table on page 10.

Example: PN45V07OB-WF3
Power cable C/W 3/8" BSP fitting

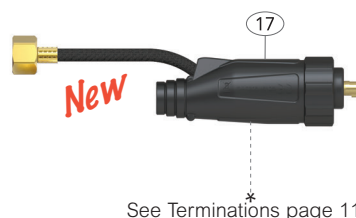
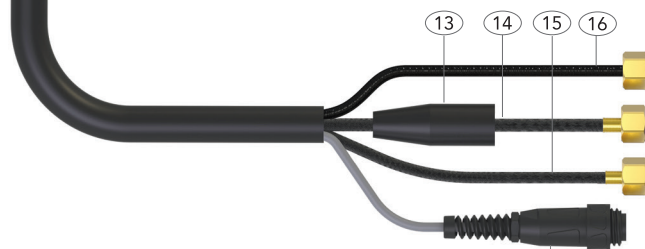

Suregrip™ Ergo Tig Torch Range

EU/UK Terminations

SGT 20

Water-Cooled Tig Welding Torch
Rating: 225A DC, 160A AC @ 100% duty cycle.

PARKER
TORCHOLOGY

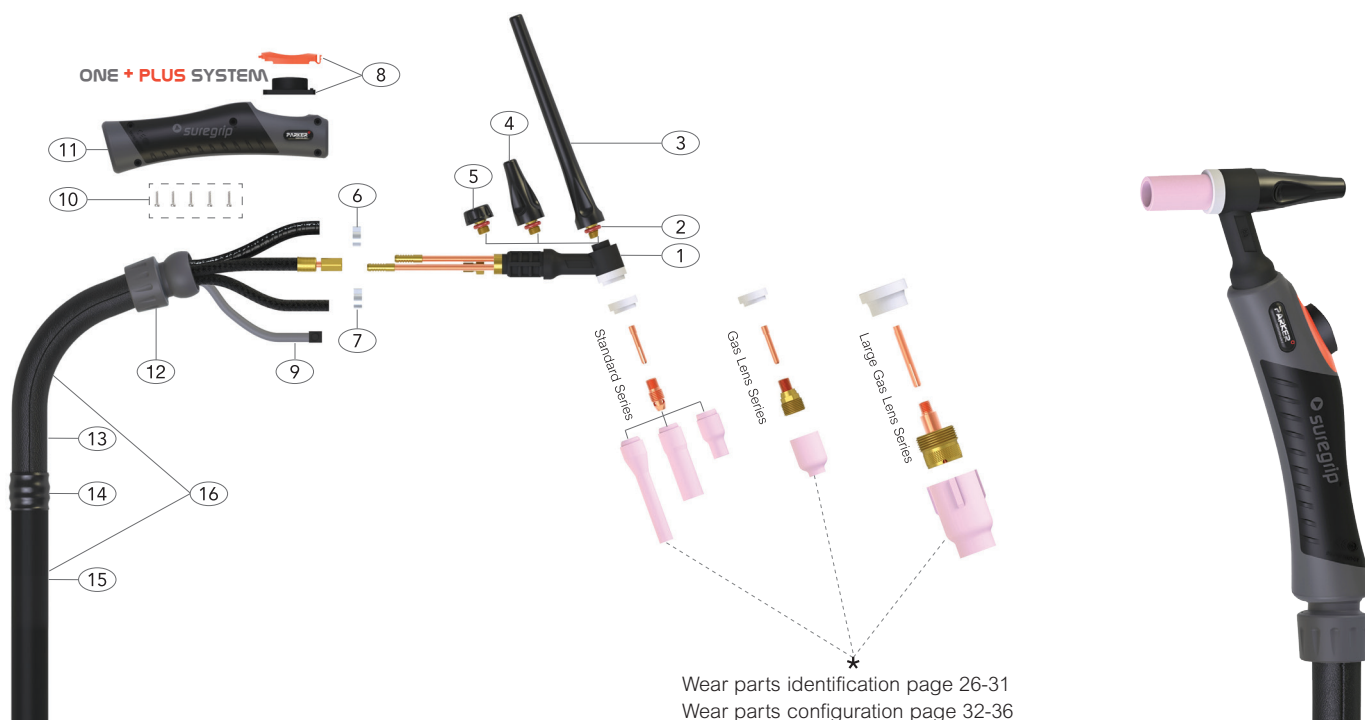

Model		
Description	Part Number	
Suregrip™ Ergo Torch Package	4M	8M
	SGT20-S1-12-EPC1-WF3-GS1	SGT20-S1-25-EPC1-WF3-GS1
Standard torch packages include S1 momentary switch		

Alternative torch packages can be configured using the configurator on page 14 or at www.parkertorchology.com

Model			
Part Number	Description	Part Number	Description
1 PWP20	Torch Body Standard	14 PERJK100	Jointing Repair Kit
2 P98W77	Back Cap 'O' Ring	15 PERNCS-32	Neoprene Cover X 3.2mt
3 P41V24	Back Cap Long	PERNCS-72	Neoprene Cover X 7.2mt
4 P41V35	Back Cap Medium	16 PERCO100-40	Sheath X 12.5ft Inc Leather Cover
5 P41V33	Back Cap Short	PERCO100-80	Sheath X 25ft Inc Leather Cover
6 PB5025S	Gas Hose Clamp 8.0mm	17 P0315071	Insulation Boot
7 PB5041	Water Hose Clamp 8.7mm	18 *P45V03OB-#	Power Cable X 12.5ft O/B
8 PER1MS	Momentary Kit	*P45V04OB-#	Power Cable X 25ft O/B
9 PERSWL4	Switch Lead 12.5ft	19 *PN45V07OB-#	Water Hose X 12.5ft O/B
PERSWL8	Switch Lead 25ft	*PN45V08OB-#	Water Hose X 25ft O/B
10 PERSP1	Screw Pack	20 *P45V09-#	Gas Hose X 12.5ft PVC
11 PERH100	Suregrip™ Small Ergo Tig Handle	*P45V10-#	Gas Hose X 25ft PVC
12 PERKJ100	Small Knuckle Joint & Lock Nut	21 POMSL3550-38BSP-S-#	Power Adaptor 3/8" BSP
13 PERLC100-08	Leather Cover X 0.8mt		

* Note: Power cable, gas and water hose assemblies are configured by utilizing the main part number and a termination suffix from the appropriate termination table on page 10.

Example: PN45V07OB-WF3

Water feed hose C/W 3/8" BSP fitting

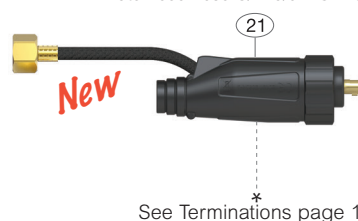

See switch plug table page 13

SGT 20S Water-Cooled Tig Welding Torch
Rating: 340A DC, 240A AC @ 100% duty cycle.

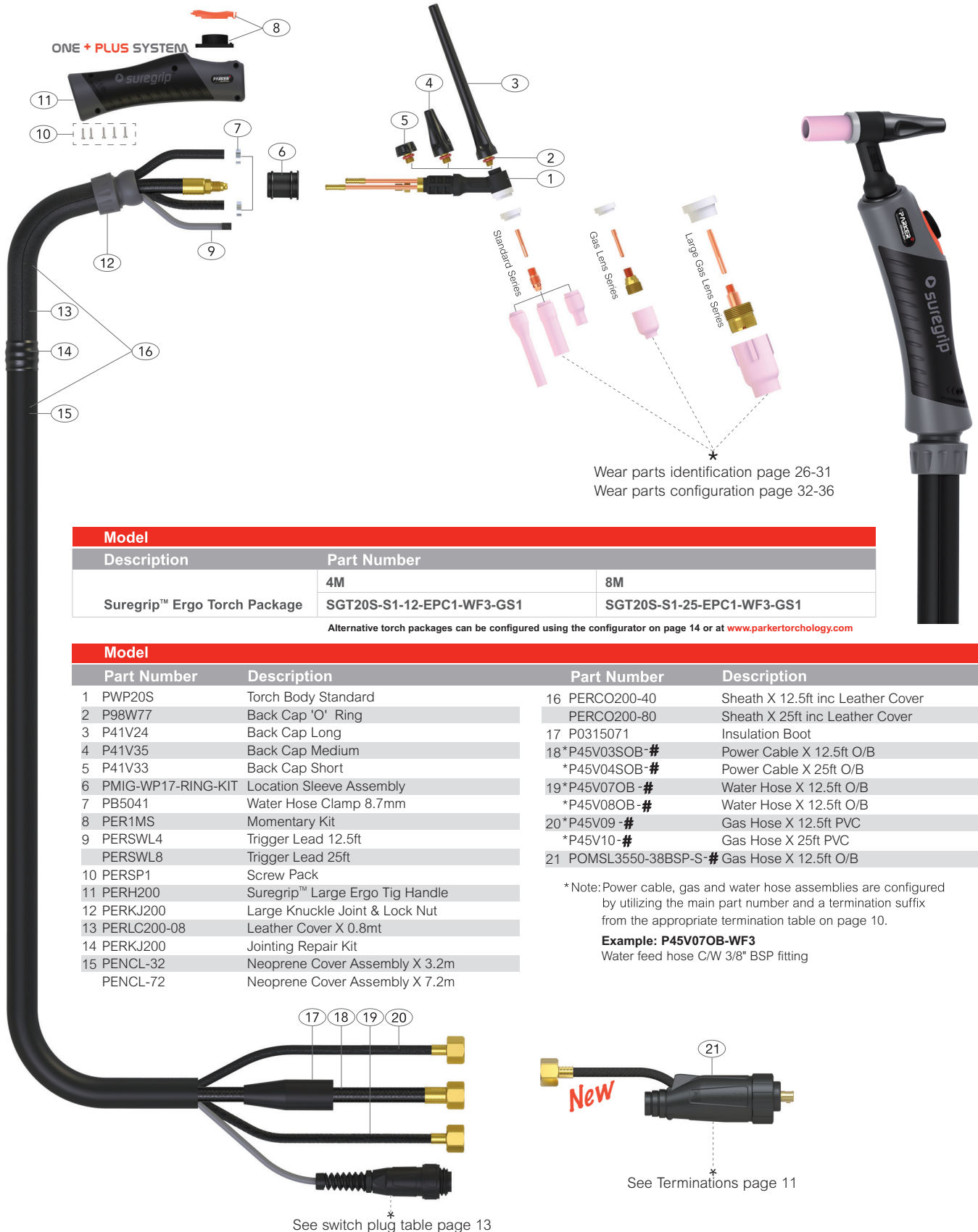

Model		
Description	Part Number	
	4M	8M
Suregrip™ Ergo Torch Package	SGT20S-S1-12-EPC1-WF3-GS1	SGT20S-S1-25-EPC1-WF3-GS1

Alternative torch packages can be configured using the configurator on page 14 or at www.parkertorchology.com

Model			
Part Number	Description	Part Number	Description
1 PWP20S	Torch Body Standard	16 PERCO200-40	Sheath X 12.5ft inc Leather Cover
2 P98W77	Back Cap 'O' Ring	16 PERCO200-80	Sheath X 25ft inc Leather Cover
3 P41V24	Back Cap Long	17 P0315071	Insulation Boot
4 P41V35	Back Cap Medium	18 *P45V03SOB-#	Power Cable X 12.5ft O/B
5 P41V33	Back Cap Short	*P45V04SOB-#	Power Cable X 25ft O/B
6 PMIG-WP17-RING-KIT	Location Sleeve Assembly	19 *P45V07OB-#	Water Hose X 12.5ft O/B
7 PB5041	Water Hose Clamp 8.7mm	*P45V08OB-#	Water Hose X 12.5ft O/B
8 PER1MS	Momentary Kit	20 *P45V09-#	Gas Hose X 12.5ft PVC
9 PERSWL4	Trigger Lead 12.5ft	*P45V10-#	Gas Hose X 25ft PVC
10 PERSWL8	Trigger Lead 25ft	21 POMSL3550-38BSP-S-#	Gas Hose X 12.5ft O/B
11 PERSP1	Screw Pack		
12 PERH200	Suregrip™ Large Ergo Tig Handle		
13 PERKJ200	Large Knuckle Joint & Lock Nut		
14 PERLC200-08	Leather Cover X 0.8mt		
15 PERKJ200	Jointing Repair Kit		
16 PENCL-32	Neoprene Cover Assembly X 3.2m		
17 PENCL-72	Neoprene Cover Assembly X 7.2m		

* Note: Power cable, gas and water hose assemblies are configured by utilizing the main part number and a termination suffix from the appropriate termination table on page 10.

Example: P45V07OB-WF3
Water feed hose C/W 3/8" BSP fitting

Suregrip™ Ergo Tig Torch Range

EU/UK Terminations

SGT 18

Water-Cooled Tig Welding Torch
Rating: 380A DC, 270A AC @ 100% duty cycle.

PARKER
TORCHOLOGY

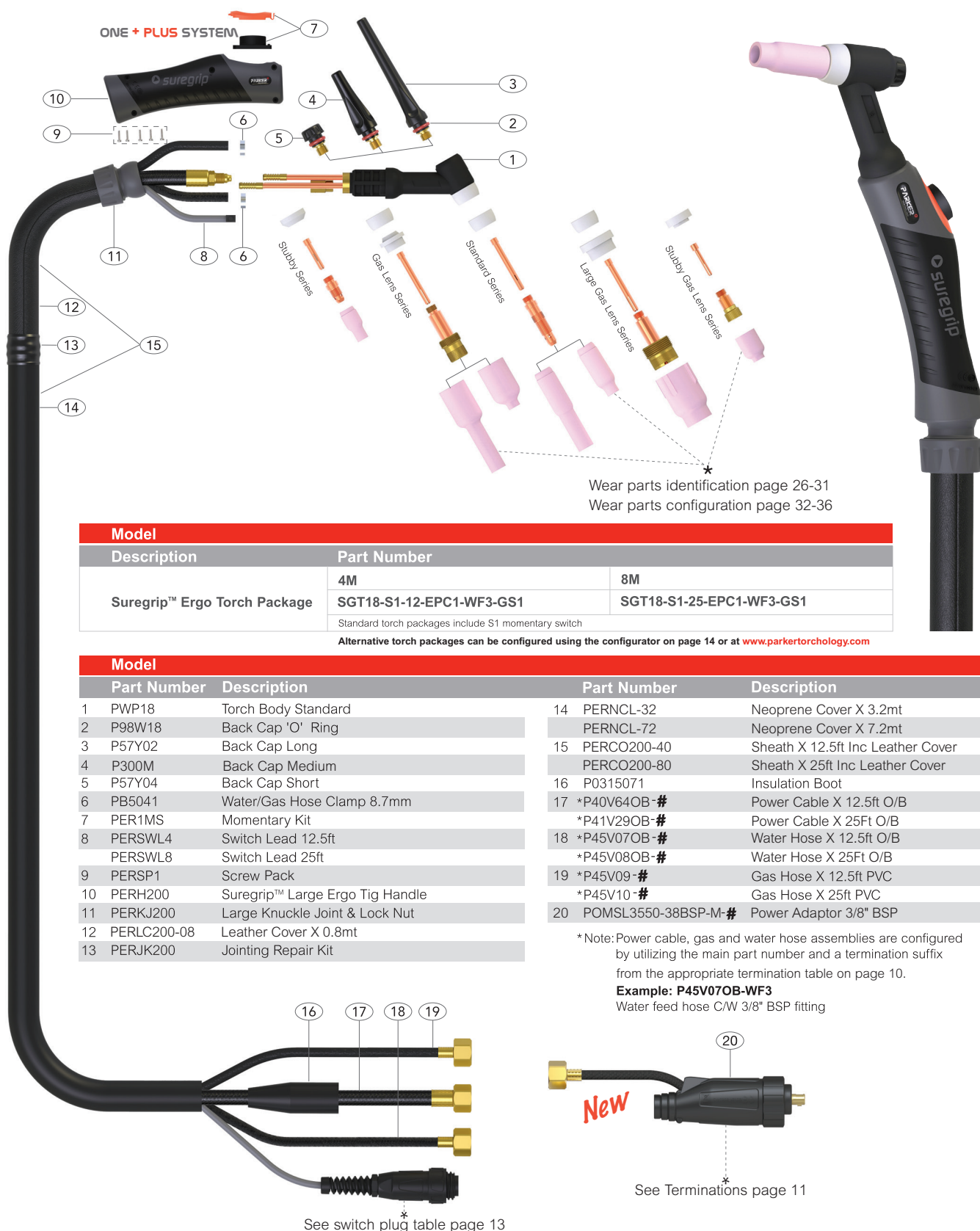

Wear parts identification page 26-31
Wear parts configuration page 32-36

Model		
Description	Part Number	
Suregrip™ Ergo Torch Package	4M	8M
	SGT18-S1-12-EPC1-WF3-GS1	SGT18-S1-25-EPC1-WF3-GS1
Standard torch packages include S1 momentary switch		

Alternative torch packages can be configured using the configurator on page 14 or at www.parkertorchology.com

Model			
Part Number	Description	Part Number	Description
1 PWP18	Torch Body Standard	14 PERNCL-32	Neoprene Cover X 3.2mt
2 P98W18	Back Cap 'O' Ring	PERNCL-72	Neoprene Cover X 7.2mt
3 P57Y02	Back Cap Long	15 PERCO200-40	Sheath X 12.5ft Inc Leather Cover
4 P300M	Back Cap Medium	PERCO200-80	Sheath X 25ft Inc Leather Cover
5 P57Y04	Back Cap Short	16 P0315071	Insulation Boot
6 PB5041	Water/Gas Hose Clamp 8.7mm	17 *P40V64OB-#	Power Cable X 12.5ft O/B
7 PER1MS	Momentary Kit	*P41V29OB-#	Power Cable X 25Ft O/B
8 PERSWL4	Switch Lead 12.5ft	18 *P45V07OB-#	Water Hose X 12.5ft O/B
PERSWL8	Switch Lead 25ft	*P45V08OB-#	Water Hose X 25Ft O/B
9 PERSP1	Screw Pack	19 *P45V09-#	Gas Hose X 12.5ft PVC
10 PERH200	Suregrip™ Large Ergo Tig Handle	*P45V10-#	Gas Hose X 25ft PVC
11 PERKJ200	Large Knuckle Joint & Lock Nut	20 POMSL3550-38BSP-M-#	Power Adaptor 3/8" BSP
12 PERLC200-08	Leather Cover X 0.8mt		
13 PERJK200	Jointing Repair Kit		

* Note: Power cable, gas and water hose assemblies are configured by utilizing the main part number and a termination suffix from the appropriate termination table on page 10.

Example: P45V07OB-WF3
Water feed hose C/W 3/8" BSP fitting

See switch plug table page 13

See Terminations page 11

SGT 18SC Water-Cooled Tig Welding Torch
Rating: 410A DC, 290A AC @ 100% duty cycle.

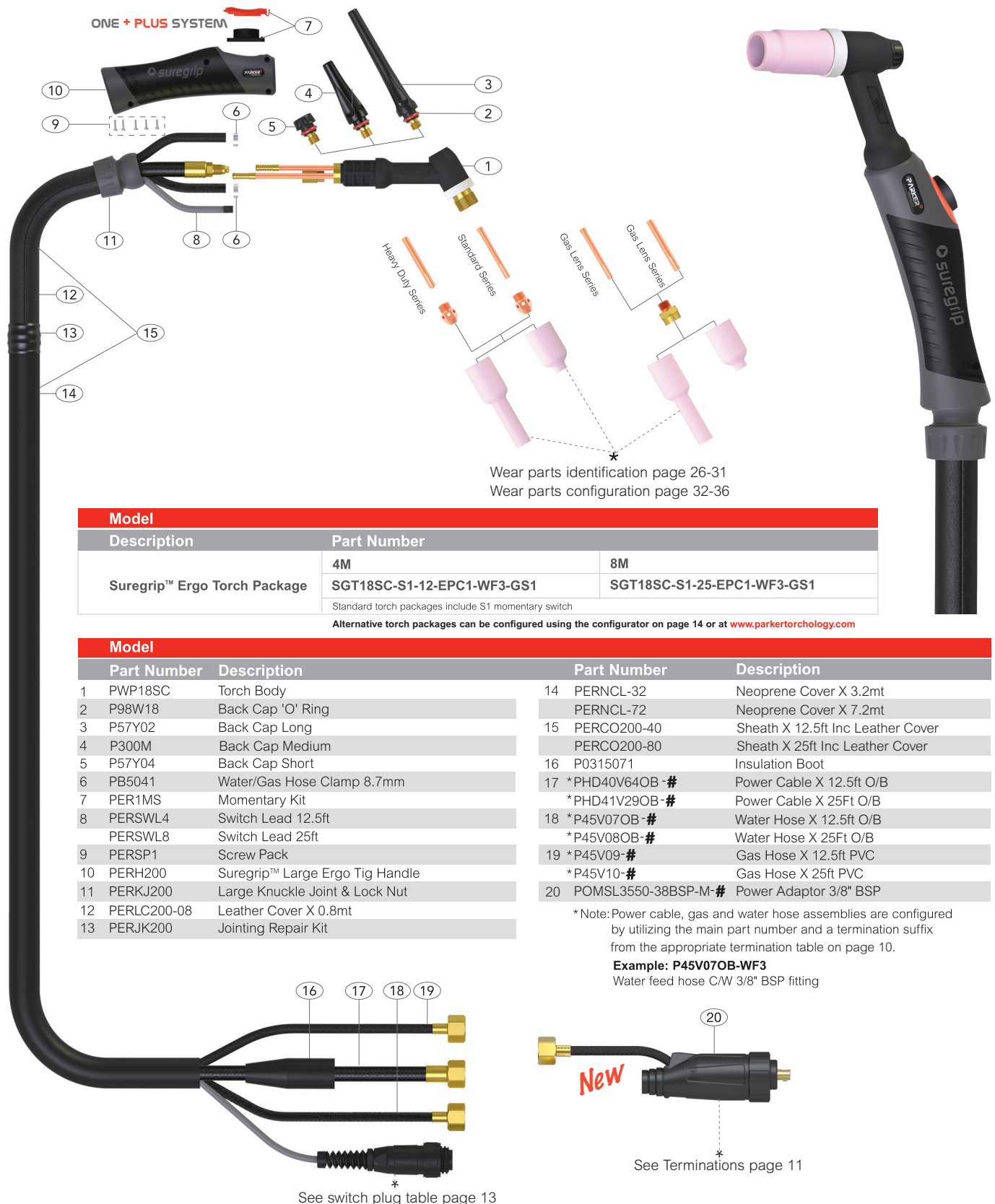

Suregrip™ Ergo Tig Torch Range

EU/UK Terminations

SGT 125M

Air-Cooled Tig Welding Torch

Rating: PM9-90 head 95A DC, 65A AC @ 35% duty cycle.

Rating: PM17-90 head 150A DC, 105A AC @ 35% duty cycle.

PARKER
TORCHOLOGY

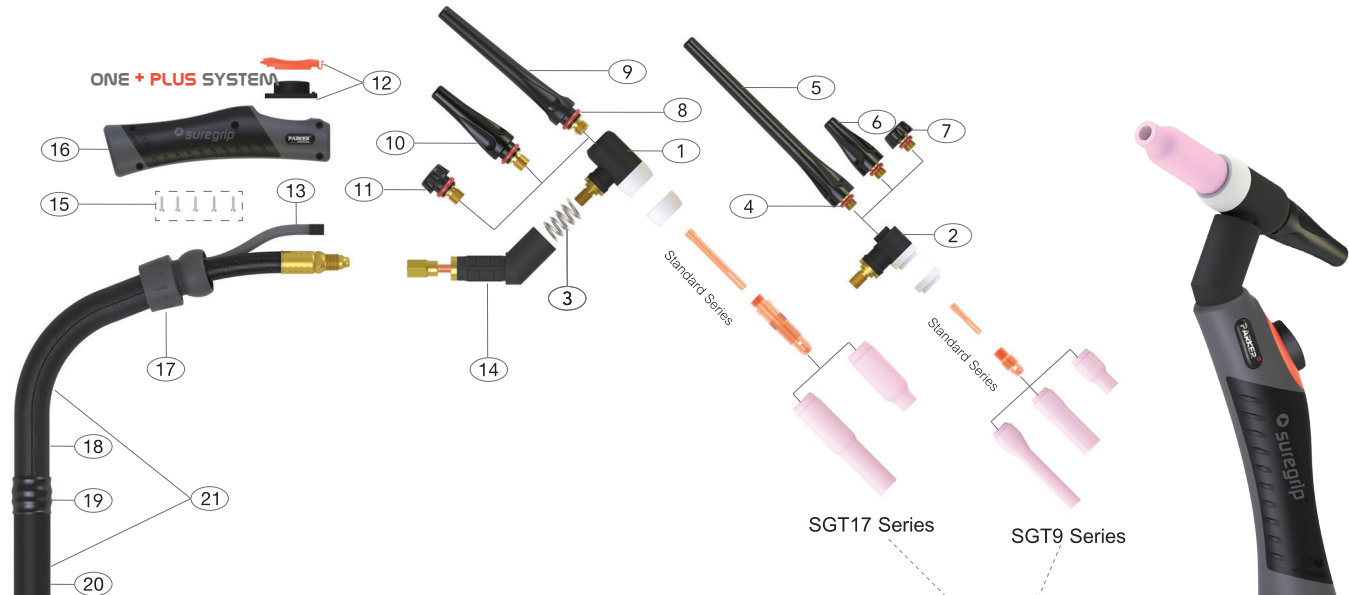

Model		
Description	Part Number	
Suregrip™ Ergo Torch Package	4M	8M
	SGTSF125M-UM17-90-S1-12-EPC1	SGTSF125M-UM17-90-S1-25-EPC1
Standard torch packages include S1 momentary switch		

Alternative torch packages can be configured using the configurator on page 14 or at www.parkertorchology.com

Model			
Part Number	Description	Part Number	Description
1	PM17-90 Torch Head 90° (Standard Set-up)	17	PERKJ100 Small Knuckle Joint & Lock Nut
2	PM17-90 Torch Head 90°	18	PERLC100-08 Leather Cover X 0.8mt
3	P4276270 Spring	19	PERJK100 Jointing Repair Kit
4	P98W77 Back Cap 'O' Ring	20	PERNCS-32 Neoprene Cover X 3.2mt
5	P41V24 Back Cap Long	21	PERNCS-72 Neoprene Cover X 7.2mt
6	P41V35 Back Cap Medium	22	PERCO100-40 Sheath X 12.5ft Inc Leather Cover
7	P41V33 Back Cap Short	23	PERCO100-80 Sheath X 25ft Inc Leather Cover
8	P98W18 Back Cap 'O' Ring	24	P0315071 Insulation Boot
9	P57Y02 Back Cap Long	25	*P57Y01OB-# Power Cable X 12.5ft O/B
10	P300M Back Cap Medium	26	*P57Y03OB-# Power Cable X 25ft O/B
11	P57Y04 Back Cap Short	27	POMSL3550-38BSP-M-# Power Adaptor 3/8" BSP
12	PER1MS Momentary Kit		
13	PERSWL4 Switch Lead 12.5ft		
14	PERSWL8 Switch Lead 25ft		
15	P125M Torch Body		
16	PERSP1 Screw Pack		
17	PERH100N Suregrip™ Small Ergo Tig Handle		

*Note: Power cable assemblies are specified by utilizing the part number and a termination suffix from the power cable/gas supply hose table on page 10.

Example: P57Y01OB-EPC1
Power cable C/W 3/8" BSP fitting

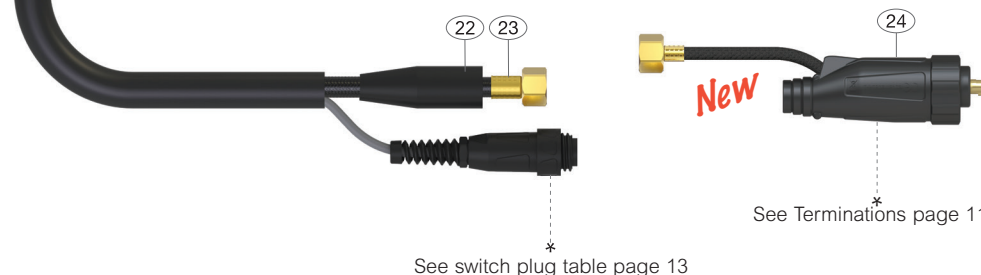

SGT 250M

Water-Cooled Tig Welding Torch

Rating: PM9-90 head 225A DC, 160A AC @ 100% duty cycle.

Rating: PM17-90 head 250A DC, 175A AC @ 100% duty cycle.

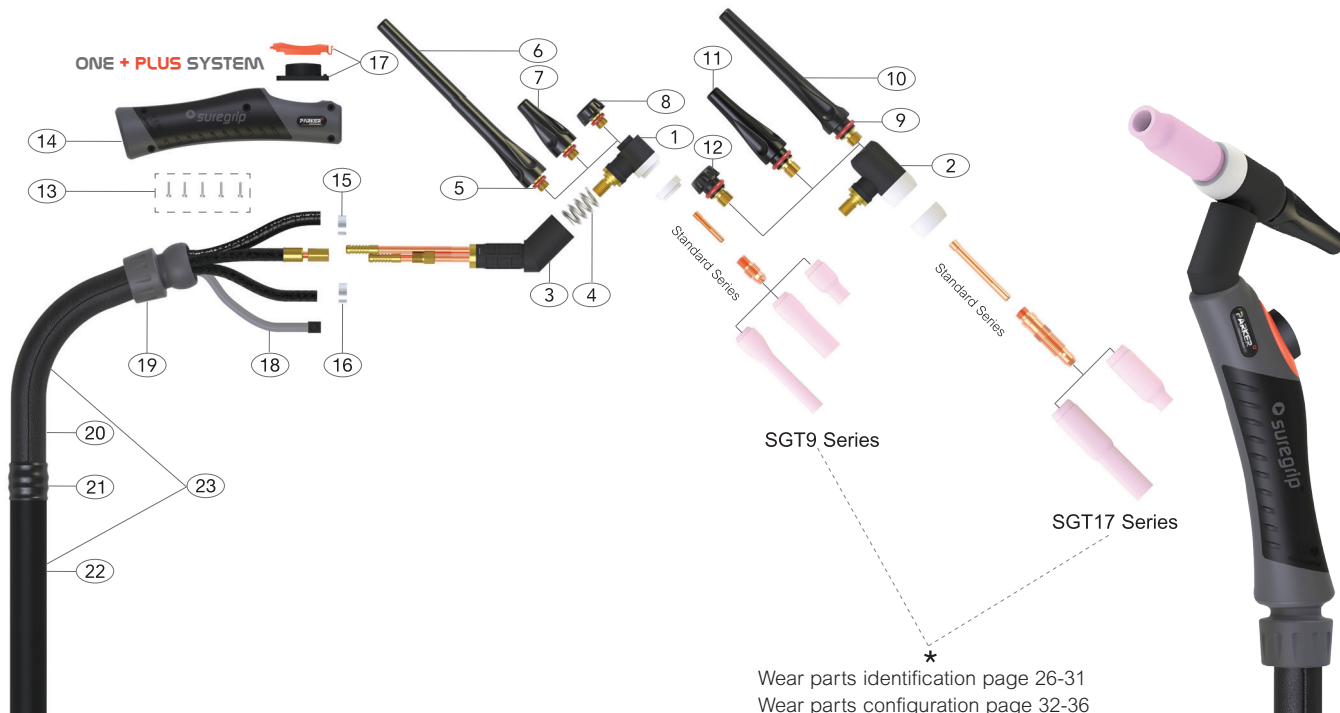

Model		
Description	Part Number	
Suregrip™ Ergo Torch Package	4M	8M
	SGTSF250M-UM9-90-S1-12-EPC1-WF3-GS1	SGTSF250M-UM9-90-S1-25-EPC1-WF3-GS1
Standard torch packages include S1 momentary switch		

Alternative torch packages can be configured using the configurator on page 14 or at www.parkertorchology.com

Model			
Part Number	Description	Part Number	Description
1	PM9-90 Torch Head 90° (Standard Set-up)	19	PERKJ100 Small Knuckle Joint & Lock Nut
2	PM17-90 Torch Head 90°	20	PERLC100-08 Leather Cover X 0.8mt
3	P250M Torch Body	21	PERJK100 Jointing Repair Kit
4	P4276270 Spring	22	PERNCS-32 Neoprene Cover X 3.2mt
5	P98W77 Back Cap 'O' Ring	23	PERNCS-72 Neoprene Cover X 7.2mt
6	P41V24 Back Cap Long	24	PERCO100-40 Sheath X 12.5ft Inc Leather Cover
7	P41V35 Back Cap Medium	25	PERCO100-80 Sheath X 25ft Inc Leather Cover
8	P41V33 Back Cap Short	26	P0315071 Insulation Boot
9	P98W18 Back Cap 'O' Ring	27	*P45V03OB-# Power Cable X 12.5ft O/B
10	P57Y02 Back Cap Long	28	*P45V04OB-# Power Cable X 25ft O/B
11	P300M Back Cap Medium		*PN45V07OB-# Water Hose X 12.5ft O/B
12	P57Y04 Back Cap Short		*PN45V08OB-# Water Hose X 25ft O/B
13	PERSP1 Screw Pack		*P45V09-# Gas Hose X 12.5ft PVC
14	PERH100N Suregrip™ Small Ergo Tig Handle		*P45V10-# Gas Hose X 25ft PVC
15	PB5025S Gas Hose Clamp 8.0mm		28 POMSL3550-38BSP-S-# Power Adaptor 3/8" BSP
16	PB5041 Water Hose Clamp 8.7mm		
17	PER1MS Momentary Kit		
18	PERSWL4 Switch Lead 12.5ft		
	PERSWL8 Switch Lead 25ft		

* Note: Power cable, gas and water hose assemblies are configured by utilizing the main part number and a termination suffix from the appropriate termination table on page 10.

Example: PN45V07OB-WF3

Water feed hose C/W 3/8" BSP fitting

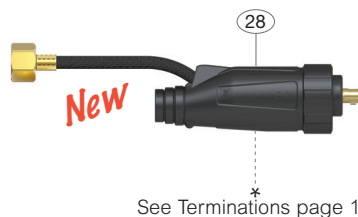
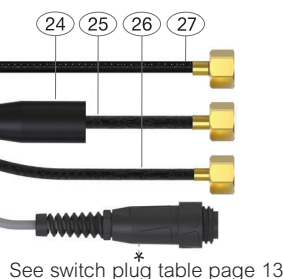

See Terminations page 11

Suregrip™ Ergo Tig Torch Range

EU/UK Terminations

SGT 225F

Water-Cooled Tig Welding Torch

Rating: P18 Series 225A DC, 160A AC @ 100% duty cycle.

Rating: P20 Series 200A DC, 140A AC @ 100% duty cycle.

Rating: P24 Series 160A DC, 115A AC @ 100% duty cycle.

PARKER
TORCHOLOGY

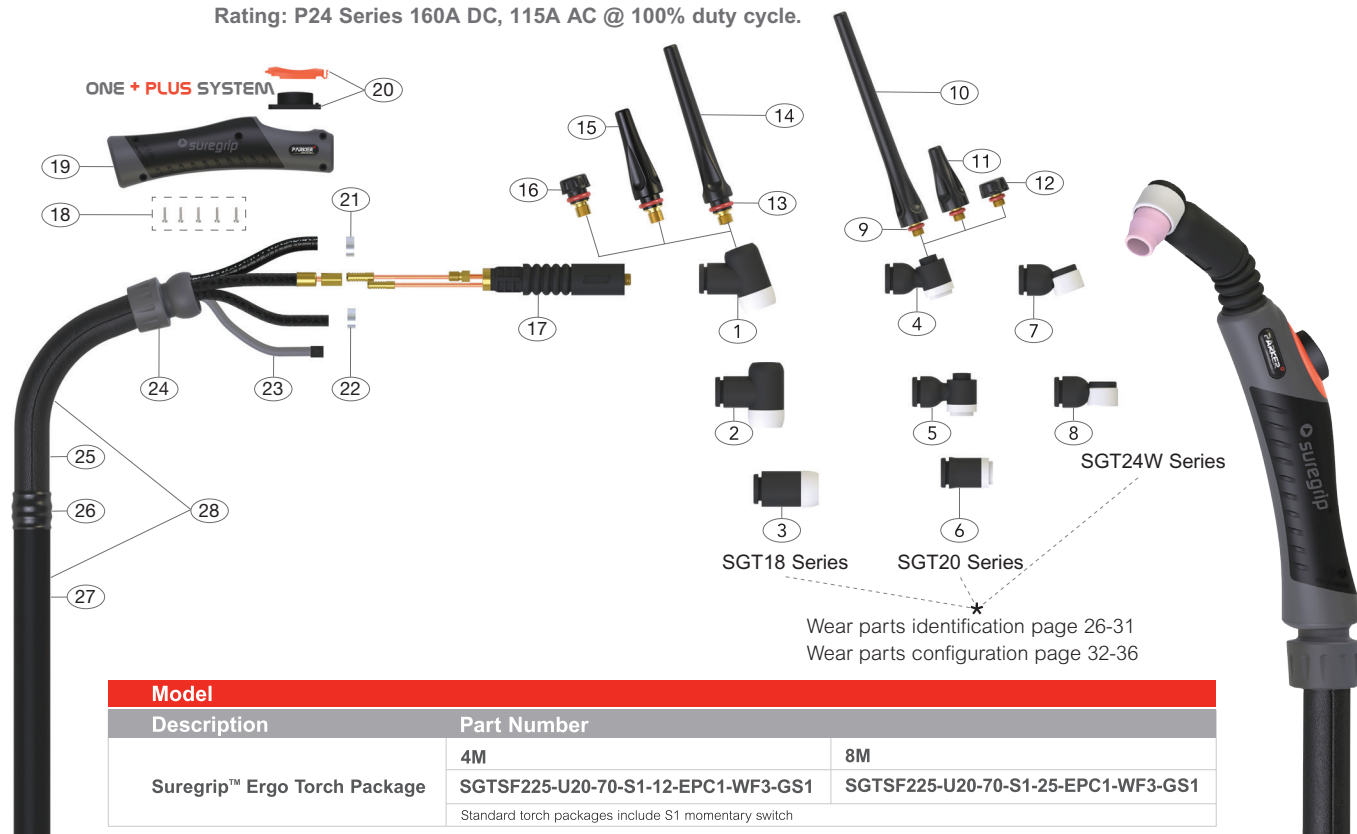

Model		
Description	Part Number	
	4M	8M
Suregrip™ Ergo Torch Package	SGTSF225-U20-70-S1-12-EPC1-WF3-GS1	SGTSF225-U20-70-S1-25-EPC1-WF3-GS1
Standard torch packages include S1 momentary switch		
Alternative torch packages can be configured using the configurator on page 14 or at www.parkertorchology.com		

Model			
Part Number	Description	Part Number	Description
1 P18-70	Torch Head 70°	23 PERSWL4	Switch Lead 12.5ft
2 P18-90	Torch Head 90°	24 PERSWL8	Switch Lead 25ft
3 P18-180	Torch Head 180°	25 PERKJ100	Small Knuckle Joint & Lock Nut
4 P20-70	Torch Head 70° (Standard Set-up)	26 PERLC100-08	Leather Cover X 0.8mt
5 P20-90	Torch Head 90°	27 PERJK100	Jointing Repair Kit
6 P20-180	Torch Head 180°	28 PERNCS-32	Neoprene Cover X 3.2mt
7 P24-70	Torch Head 70°	29 PERNCS-72	Neoprene Cover X 7.2mt
8 P24-90	Torch Head 90°	30 PERCO100-40	Sheath X 12.5ft Inc Leather Cover
9 P98W77	Back Cap 'O' Ring	31 PERCO100-80	Sheath X 25ft Inc Leather Cover
10 P41V24	Back Cap Long	32 P03150711	Insulation Boot
11 P41V35	Back Cap Medium	33 *P45V03OB-#	Power Cable X 12.5ft O/B
12 P41V33	Back Cap Short	*P45V04OB-#	Power Cable X 25ft O/B
13 P98W18	Back Cap 'O' Ring	*PN45V07OB-#	Water Hose X 12.5ft O/B
14 P57Y02	Back Cap Long	*PN45V08OB-#	Water Hose X 25ft O/B
15 P300M	Back Cap Medium	32 *P45V09-#	Gas Hose X 12.5ft PVC
16 P57Y04	Back Cap Short	*P45V10-#	Gas Hose X 25ft PVC
17 P225F	Torch Body	33 POMSL3550-38BSP-S-#	Power Adaptor 3/8" BSP
18 PERSP1	Screw Pack		
19 PERH100	Suregrip™ Small Ergo Tig Handle		
20 PER1MS	Momentary Kit		
21 PB5025S	Gas Hose Clamp 8.0mm		
22 PB5041	Water Hose Clamp 8.7mm		

*Note: Power cable, gas and water hose assemblies are configured by utilizing the main part number and a termination suffix from the appropriate termination table on page 10.

Example: PN45V07OB-WF3

Water feed hose C/W 3/8" BSP fitting

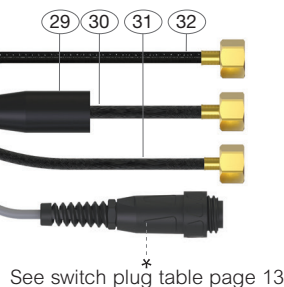

See switch plug table page 13



See Terminations page 11

Standard Collets

SGT 17/18/18SC/26/125M/250M/225F		
Part No.	Description	Electrode Size
		MM INCH
P10N21	Standard Collet	0.5 0.020
P10N22	Standard Collet	1.0 0.040
P10N23	Standard Collet	1.6 1/16
P10N23M	Standard Collet	2.0 5/64
P10N24	Standard Collet	2.4 3/32
P10N25	Standard Collet	3.2 1/8

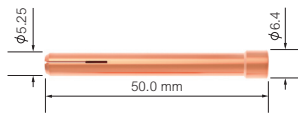

SGT 9/20/20S/125M/250M/225F		
Part No.	Description	Electrode Size
		MM INCH
P13N20	Standard Collet	0.5 0.020
P13N21	Standard Collet	1.0 0.040
P13N22	Standard Collet	1.6 1/16
P13N22M	Standard Collet	2.0 5/64
P13N23	Standard Collet	2.4 3/32

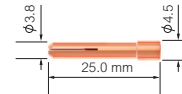

SGT 18/18SC/125M/250M/225F		
Part No.	Description	Electrode Size
		MM INCH
P54N20	Standard Collet	4.0 5/32

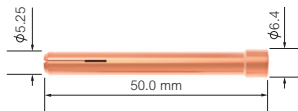

SGT 20/20S/125M/250M/225F		
Part No.	Description	Electrode Size
		MM INCH
P13N24	Standard Collet	3.2 1/8

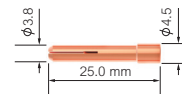

SGT 24W/225F		
Part No.	Description	Electrode Size
		MM INCH
P53N14	Standard Collet	1.6 1/16
P53N16	Standard Collet	1.0 0.040



Heavy Duty Collets

SGT 18SC		
Part No.	Description	Electrode Size
		MM INCH
P10N25HD	Heavy Duty Collet	3.2 1/8
P54N20HD	Heavy Duty Collet	4.0 5/32
P18C36	Heavy Duty Collet	4.8 3/16

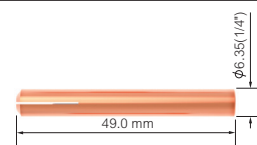

Stubby Series Collets

SGT		17/18/26/125M/250M/225F	
Part No.	Description	Electrode Size	
		MM	INCH
P10N21S	Stubby Series Collet	0.5	0.020
P10N22S	Stubby Series Collet	1.0	0.040
P10N23S	Stubby Series Collet	1.6	1/16
P10N24S	Stubby Series Collet	2.4	3/32
P10N25S	Stubby Series Collet	3.2	1/8

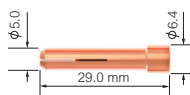

Large Diameter Gas Lens Collets

SGT		9/20/20S/125M/250M/225F	
Part No.	Description	Electrode Size	
		MM	INCH
P13N20L	Large Diameter Gas Lens Collet	0.5	0.020
P13N21L	Large Diameter Gas Lens Collet	1.0	0.040
P13N22L	Large Diameter Gas Lens Collet	1.6	1/16
P13N23L	Large Diameter Gas Lens Collet	2.4	3/32
P13N24L	Large Diameter Gas Lens Collet	3.2	1/8

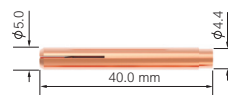

Stubby Series Collets

SGT		17/18/26/125M/250M/225F	
Part No.	Description	Electrode Size	
		MM	INCH
PSTB13N20	Stubby Series Collet	0.5	0.020
PSTB13N21	Stubby Series Collet	1.0	0.040
PSTB13N22	Stubby Series Collet	1.6	1/16
PSTB13N22M	Stubby Series Collet	2.0	5/64
PSTB13N23	Stubby Series Collet	2.4	3/32

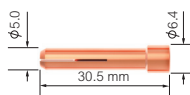

Standard Collet Bodies

SGT		17/18/26/125M/250M/225F	
Part No.	Description	Electrode Size	
		MM	INCH
P10N28	Standard Collet Body	3.2	1/8
P10N29	Standard Collet Body	0.5	0.020
P10N30	Standard Collet Body	1.0	0.040
P10N31	Standard Collet Body	1.6	1/16
P10N31M	Standard Collet Body	2.0	5/64
P10N32	Standard Collet Body	2.4	3/32

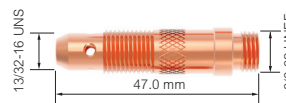

Gas Lens Collets

SGT		24W/225F	
Part No.	Description	Electrode Size	
		MM	INCH
P53N64	Gas Lens Collet	1.6	1/16

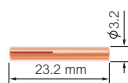

SGT		18/250M/225F	
Part No.	Description	Electrode Size	
		MM	INCH
P406488	Standard Collet Body	4.0	5/32

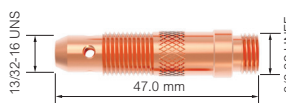

Standard Collet Bodies

SGT		9/20/20S/125M/250M/225F	
Part No.	Description	Electrode Size	
		MM	INCH
P13N25	Standard Collet Body	0.5	0.020
P13N26	Standard Collet Body	1.0	0.040
P13N27	Standard Collet Body	1.6	1/16
P13N27M	Standard Collet Body	2.0	5/64
P13N28	Standard Collet Body	2.4	3/32
P13N29	Standard Collet Body	3.2	1/8

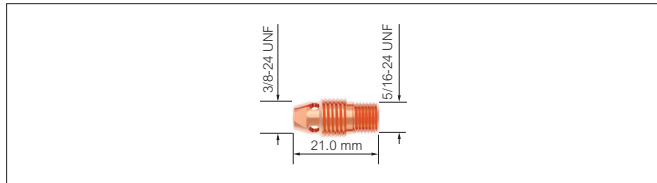

Standard Collet Bodies

SGT		24W/225F	
Part No.	Description	Electrode Size	
		MM	INCH
P53N18	Standard Collet Body	1.0	0.040
P53N19	Standard Collet Body	1.6	1/16
P24CB332	Standard Collet Body	2.4	3/32

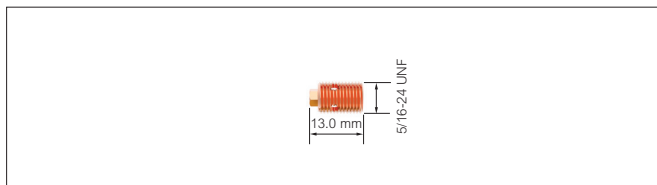

Heavy Duty Collet Bodies

SGT		18SC	
Part No.	Description	Bore	
		MM	
PNCB-53	Standard Nose Collet Body	3.4	

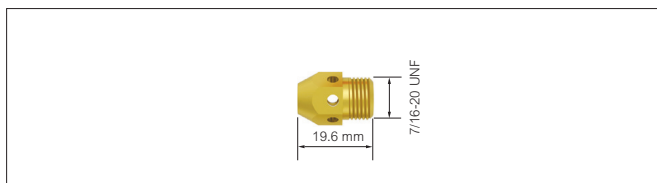

SGT		18SC	
Part No.	Description	Bore	
		MM	
PNCB-36	Heavy Duty Nose Collet Body	5.0	

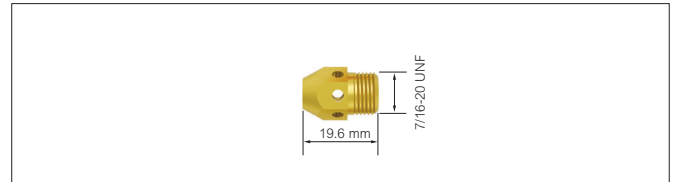

Stubby Collet Bodies

SGT		17/18/26/125M/250M/225F	
Part No.	Description	Bore	
		MM	
P17CB20	Stubby Collet Body	3.5	

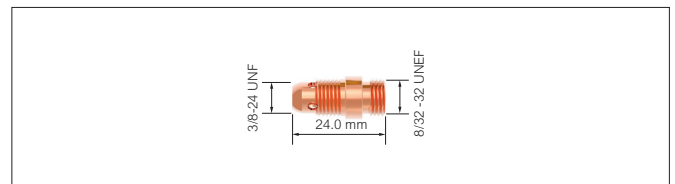

SGT		17/18/26/125M/250M/225F	
Part No.	Description	Electrode Size	
		MM	INCH
P45V24	Gas Lens Body	1.0	0.040
P45V25	Gas Lens Body	1.6	1/16
P45V25M	Gas Lens Body	2.0	5/64
P45V26	Gas Lens Body	2.4	3/32
P45V27	Gas Lens Body	3.2	1/8
P45V28	Gas Lens Body	4.0	5/32
P45V29	Gas Lens Body	0.5	0.020

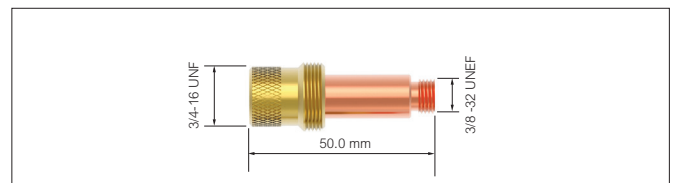

Gas Lens Bodies

SGT 9/20/24W/125M/250M/225F		Electrode Size	
Part No.	Description	MM	INCH
P45V41	Gas Lens Body	0.5	0.020
P45V42	Gas Lens Body	1.0	0.040
P45V43	Gas Lens Body	1.6	1/16
P45V43M	Gas Lens Body	2.0	5/64
P45V44	Gas Lens Body	2.4	3/32

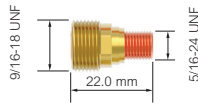

SGT 9/20/20S/125M/250M/225F		Electrode Size	
Part No.	Description	MM	INCH
P45V45	Gas Lens Body	3.2	1/8

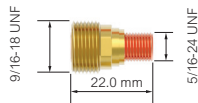

SGT 18SC		Electrode Size	
Part No.	Description	MM	INCH
P18GL16	Gas Lens Body	1.6	1/16
P18GL32	Gas Lens Body	2.4	3/32
P18GL18	Gas Lens Body	3.2	1/8
P18GL53	Gas Lens Body	4.0	5/32
P18GL36	Gas Lens Body	4.8	3/16

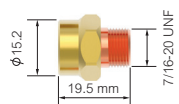

Stubby Gas Lens Bodies

SGT 17/18/26/125M/250M/225F		Electrode Size	
Part No.	Description	MM	INCH
PSTB45V41	Stubby Gas Lens Body	0.5	0.020
PSTB45V42	Stubby Gas Lens Body	1.0	0.040
PSTB45V43	Stubby Gas Lens Body	1.6	1/16
PSTB45V43M	Stubby Gas Lens Body	2.0	5/64
PSTB45V44	Stubby Gas Lens Body	2.4	3/32
PSTB45V45	Stubby Gas Lens Body	3.2	1/8

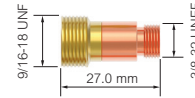

Large Diameter Gas Lens Bodies

SGT 17/18/26/125M/250M/225F		Electrode Size	
Part No.	Description	MM	INCH
P45V0204	Large Diameter Gas Lens Body	1.0	0.040
P45V116	Large Diameter Gas Lens Body	1.6	1/16
P45V64	Large Diameter Gas Lens Body	2.4	3/32
P45V63	Large Diameter Gas Lens Body	4.0	5/32
P995795	Large Diameter Gas Lens Body	3.2	1/8

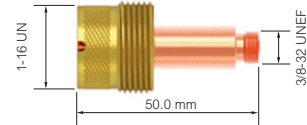

Large Diameter Gas Lens Bodies

SGT 9/20/20S/125M/250M/225F		Electrode Size	
Part No.	Description	MM	INCH
P45V0204S	Large Diameter Gas Lens Body	1.0	0.040
P45V116S	Large Diameter Gas Lens Body	1.6	1/16
P45V64S	Large Diameter Gas Lens Body	2.4	3/32
P45V63S	Large Diameter Gas Lens Body	4.0	5/32

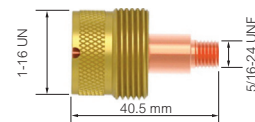

Large Diameter Gas Lens Bodies

SGT 20/125M/250M/225F	
Part No.	Description
Electrode Size	
	MM INCH
P995795S	Large Diameter Gas Lens Body
	3.2 1/8

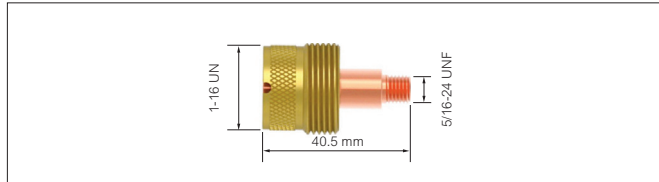

SGT 24W/225F	
Part No.	Description
Size	
BoreA	
	MM INCH
P53N24	Standard Ceramic Cup
P53N25	Standard Ceramic Cup
P53N27	Standard Ceramic Cup
	4 6 1/4
	5 8 5/16
	6 10 3/8

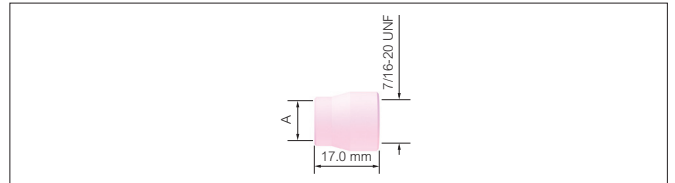

Standard Ceramic Cups

SGT 17/18/26/125M/250M/225F	
Part No.	Description
Size	
BoreA	
	MM INCH
P10N44	Standard Ceramic Cup
P10N45	Standard Ceramic Cup
P10N46	Standard Ceramic Cup
P10N47	Standard Ceramic Cup
P10N48	Standard Ceramic Cup
P10N49	Standard Ceramic Cup
P10N50	Standard Ceramic Cup
	12 19 3/4
	10 16 5/8
	8 12.5 1/2
	7 11 7/16
	6 10 3/8
	5 8 5/16
	4 6 1/4

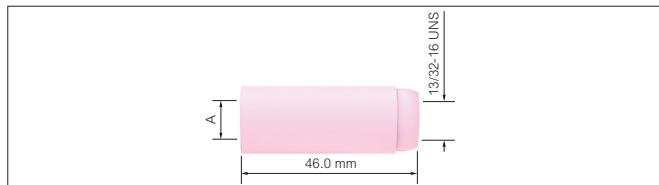

Standard Long Ceramic Cups

SGT 17/18/26/125M/250M/225F	
Part No.	Description
Size	
BoreA	
	MM INCH
P10N47L	Standard Long Ceramic Cup
P10N48L	Standard Long Ceramic Cup
P10N49L	Standard Long Ceramic Cup
	7L 11 7/16
	6L 10 3/8
	5L 8 5/16

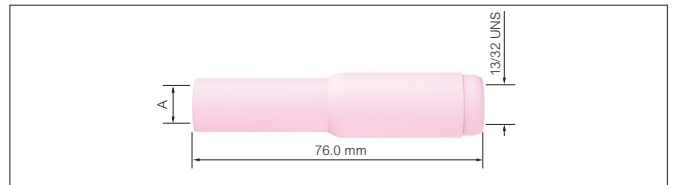

SGT 9/17/18/20/20S/26/125M/250M/225F	
Part No.	Description
Size	
BoreA	
	MM INCH
P13N08	Standard Ceramic Cup
P13N09	Standard Ceramic Cup
P13N10	Standard Ceramic Cup
P13N11	Standard Ceramic Cup
P13N12	Standard Ceramic Cup
P13N13	Standard Ceramic Cup
	4 6 1/4
	5 8 5/16
	6 10 3/8
	7 11 7/16
	8 12.5 1/2
	10 16 5/8

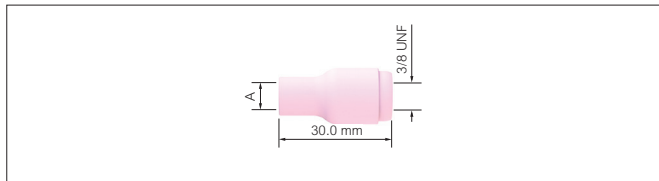

SGT 9/20/20S/125M/250M/225F	
Part No.	Description
Size	
BoreA	
	MM INCH
P796F70	Standard Long Ceramic Cup
P796F71	Standard Long Ceramic Cup
P796F72	Standard Long Ceramic Cup
P796F73	Standard Long Ceramic Cup
	3 5 3/16
	4 6 1/4
	5 8 5/16
	6 10 3/8

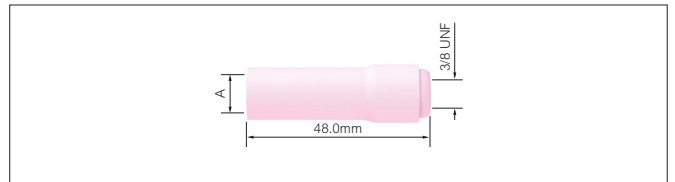

Standard Extra Long Ceramic Cups

SGT 9/20/20S/125M/250M/225F				
Part No.	Description	Size	BoreA	
			MM	INCH
P796F74	Standard Extra Long Ceramic Cup	3	5	3/16
P796F75	Standard Extra Long Ceramic Cup	4	6	1/4
P796F76	Standard Extra Long Ceramic Cup	5	8	5/16
P796F77	Standard Extra Long Ceramic Cup	6	10	3/8

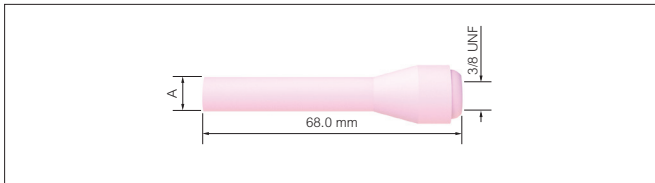

Long Gas Lens Ceramic Cups

SGT 17/18/18SC/26/125M/250M/225F				
Part No.	Description	Size	BoreA	
			MM	INCH
P54N15L	Long Gas Lens Ceramic Cup	7	11	7/16
P54N16L	Long Gas Lens Ceramic Cup	6	10	3/8
P54N17L	Long Gas Lens Ceramic Cup	5	8	5/16

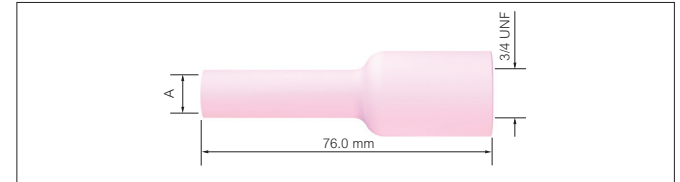

Gas Lens Cups

SGT 9/17/18/20/20S/24W/26/125M/250M/225F				
Part No.	Description	Size	BoreA	
			MM	INCH
P53N58	Gas Lens Cup	4	6	1/4
P53N59	Gas Lens Cup	5	8	5/16
P53N60	Gas Lens Cup	6	10	3/8
P53N61	Gas Lens Cup	7	11	7/16
P53N61S	Gas Lens Cup	8	12.5	1/2

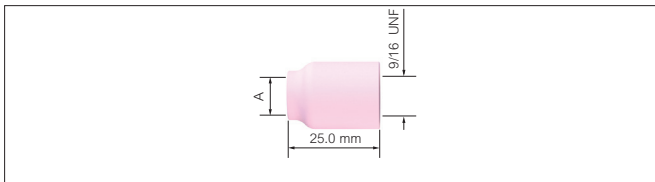

Large Diameter Gas Lens Cups

SGT 9/17/18/20/20S/26/125M/250M/225F				
Part No.	Description	Size	BoreA	
			MM	INCH
P57N74	Large Diameter Gas Lens Cup	8	12.5	1/2
P57N75	Large Diameter Gas Lens Cup	6	10	3/8
P53N87	Large Diameter Gas Lens Cup	12	19	3/4
P53N88	Large Diameter Gas Lens Cup	10	16	5/8

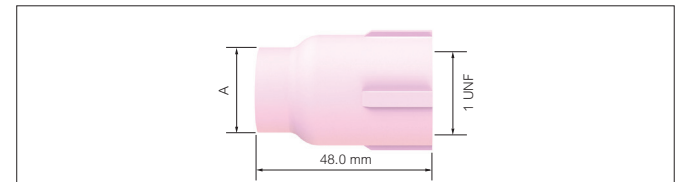

SGT 17/18/18SC/26/125M/250M/225F				
Part No.	Description	Size	BoreA	
			MM	INCH
P54N14	Gas Lens Cup	8	12.5	1/2
P54N15	Gas Lens Cup	7	11	7/16
P54N16	Gas Lens Cup	6	10	3/8
P54N17	Gas Lens Cup	5	8	5/16
P54N18	Gas Lens Cup	4	6	1/4
P54N19	Gas Lens Cup	11	17	11/16

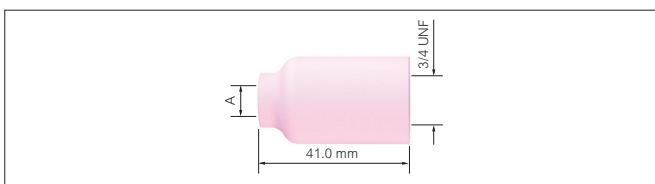



WeldTronic

Weldtronic International P/L

A.B.N 93 007 242 355

P.O Box 2096 Rowville Victoria 3178 Australia

Tel. +613 9702 9366 Fax. +613 9702 9766

E. sales@weldtronic.com.au

W. www.weldtronic.com.au